

**Club Car** **Precedent**

# **A-Arm Lift Kit**

instruction manual

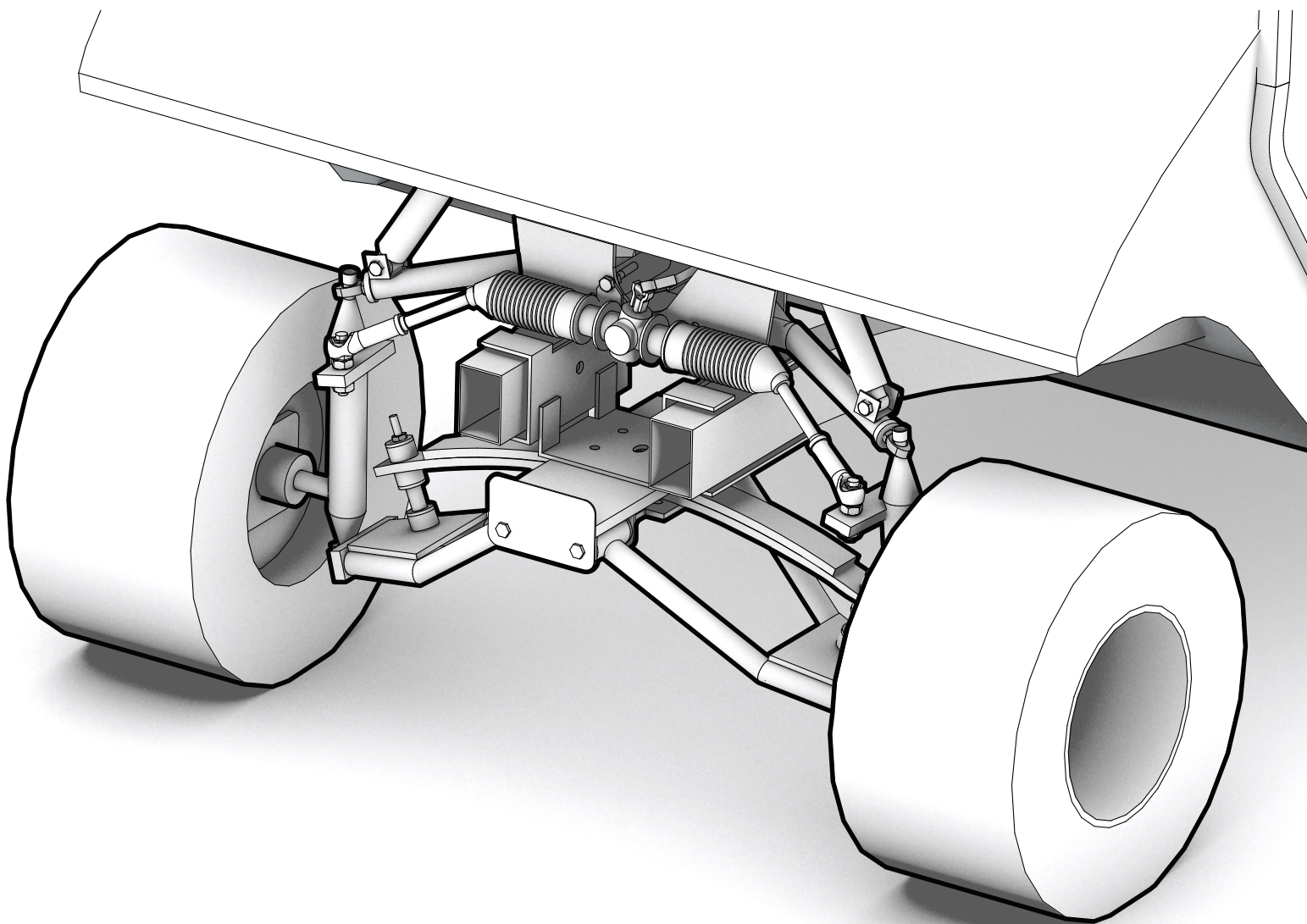

[WWW.AllSportsLiftKits.com](http://WWW.AllSportsLiftKits.com)

1-866-291-5244



# Parts List

## Front Suspension (**3", 4", & 6" A-ARM**) Steps 1 - 12

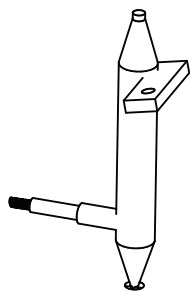

Spindle Body (2)

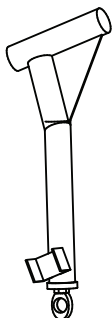

Control Arm (2)

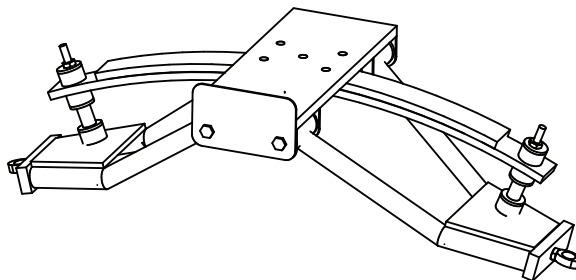

A-Arm Assembly

## Rear Suspension (**4" & 6" A-ARM**) Steps 13.a - 20.a

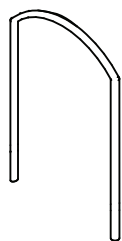

U-Bolt (4)

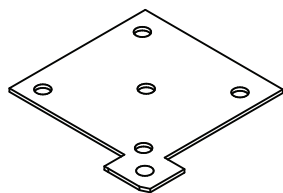

6-hole Shock Plate (2)

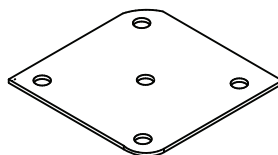

5-hole Bottom Plate (2)

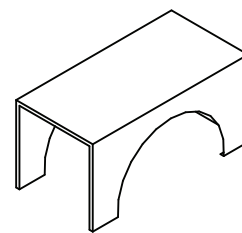

Axle Seat (2)

## Rear Suspension (**3" A-ARM**) Steps 13.b - 20.b

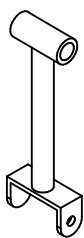

Shackle Extension (2)



Shock Thread Extension (2)

## Nuts & Bolts (**3", 4", & 6" A-ARM**)

Allen Bolt  
[1/4" head]  
1/2" x 1 - 1/2"  
(4)

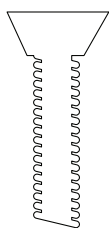

Patch Bolt  
13mm x 1 - 1/2"  
(4)

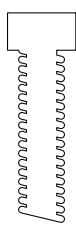

3/8" Washer  
(8)

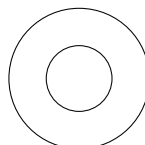

3/8" Nyloc Nut  
(8)



# Installation Front end disassembly

## 1. Raise cart and support frame.

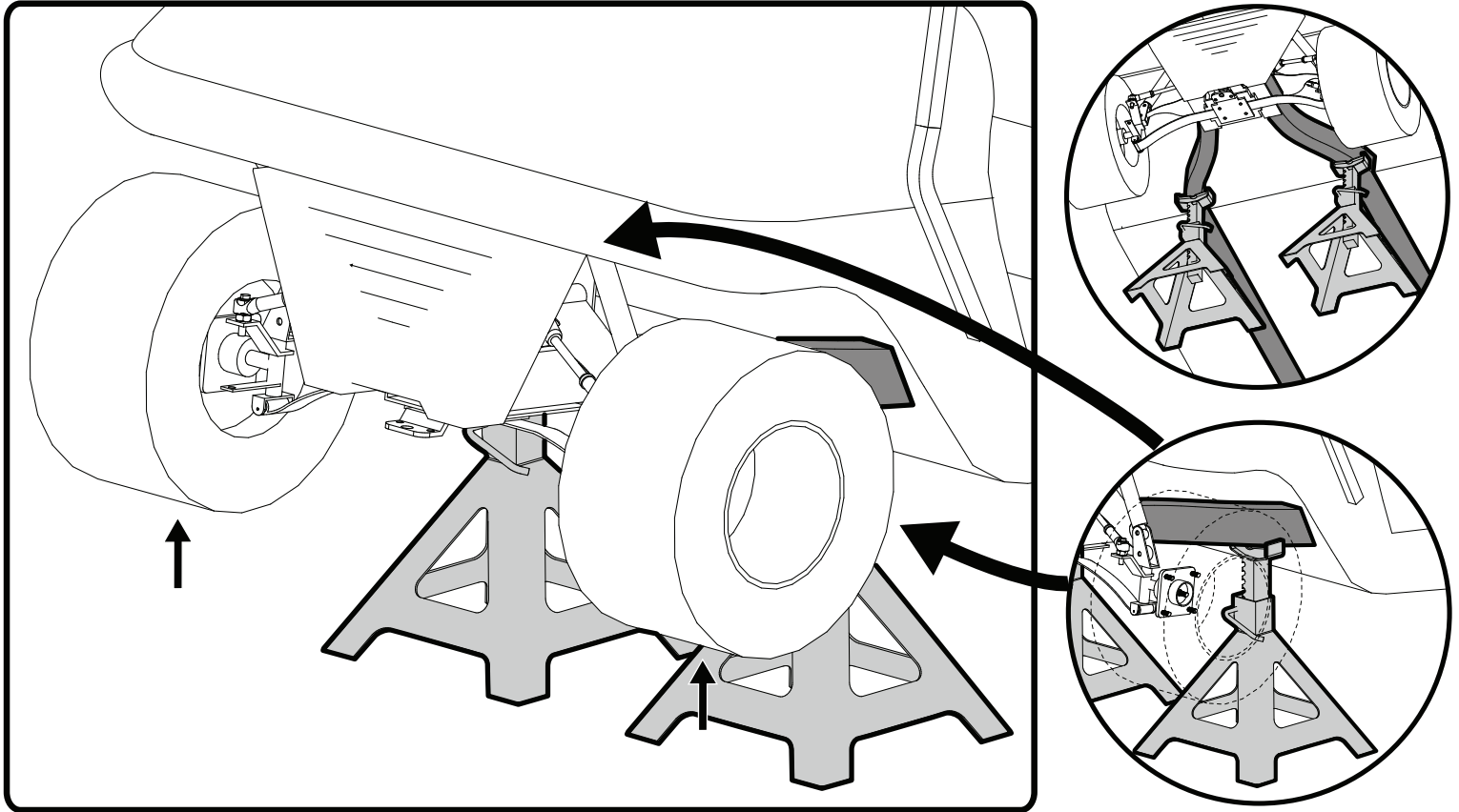

Support front frame rails with jack stands and raise until front wheels clear the ground.

## 2. Remove front bumper.

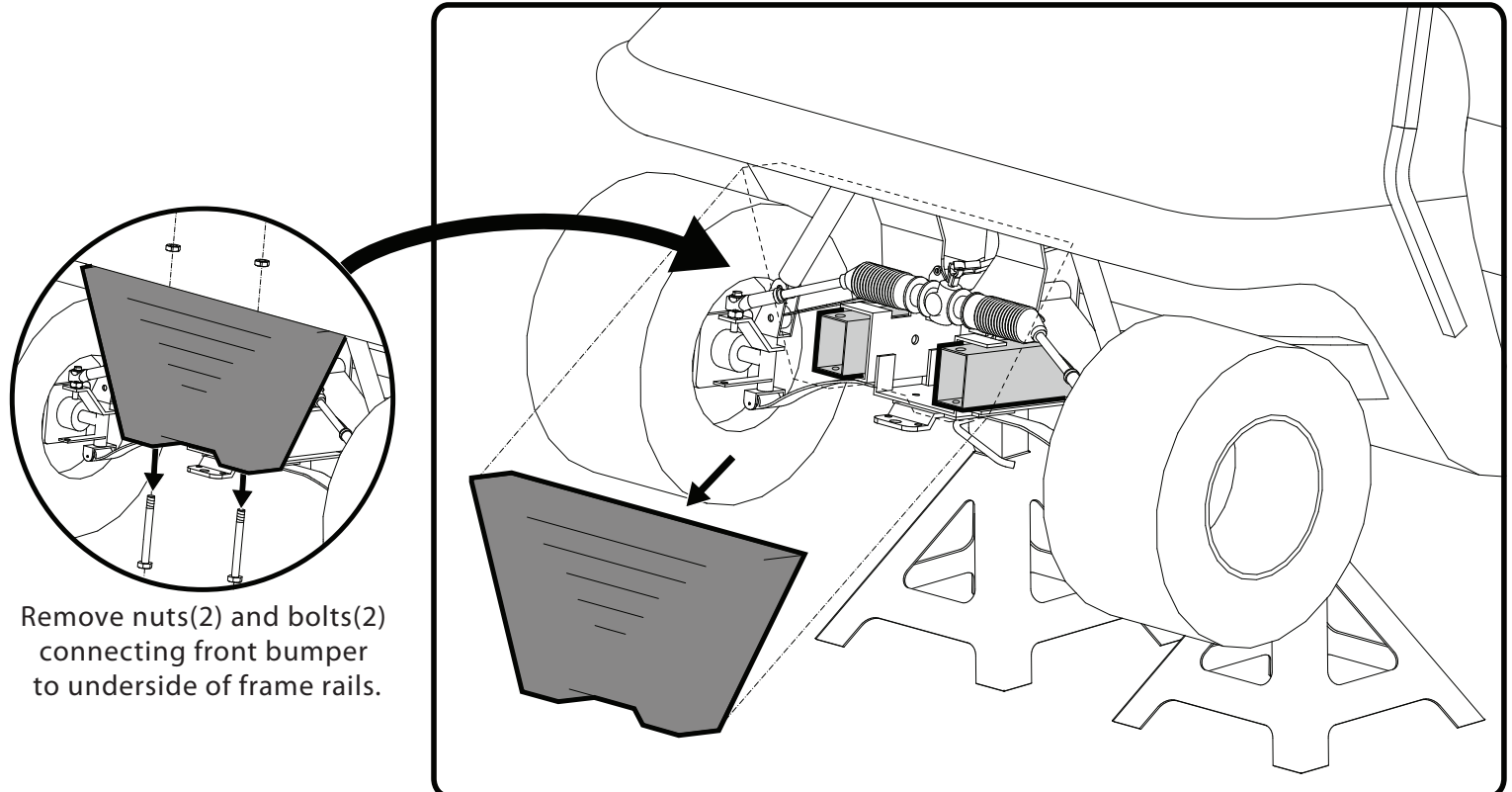

# Installation

Front end disassembly

## 3. Remove wheels.

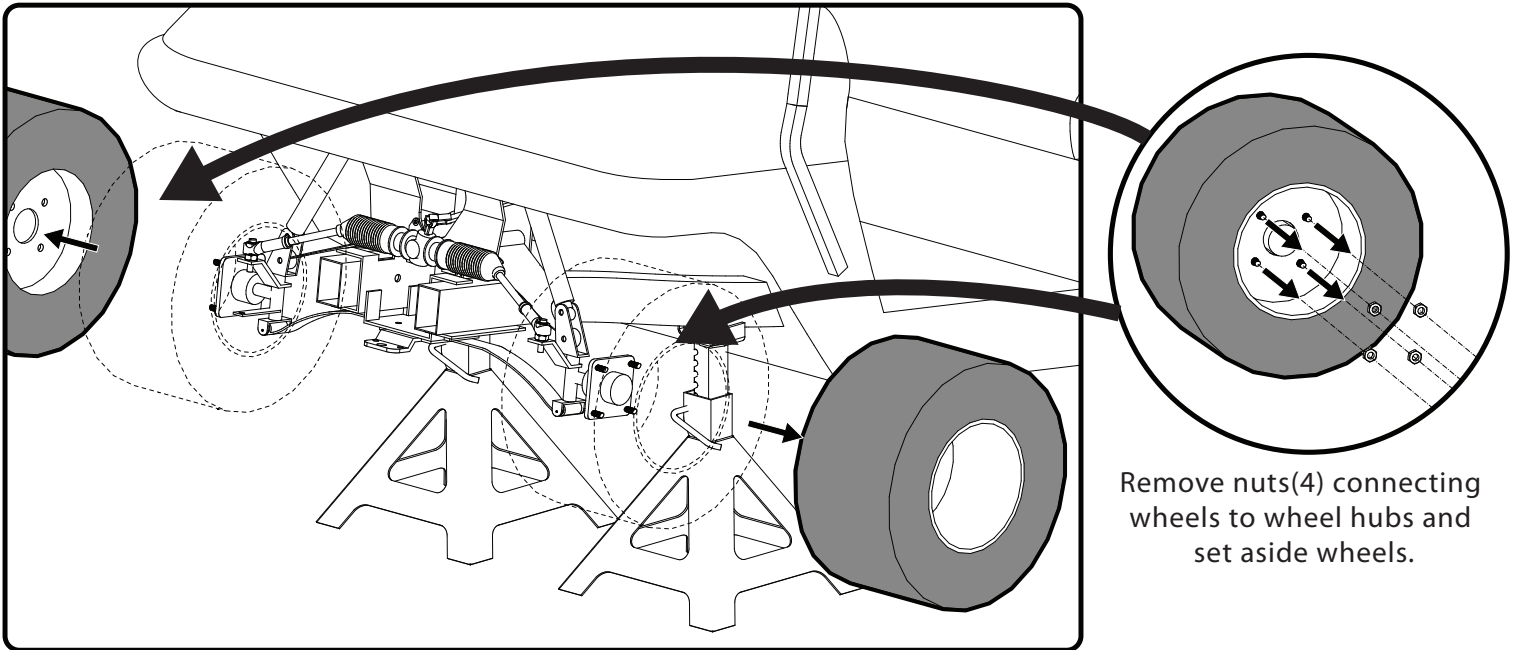

## 4. Remove wheel hubs.

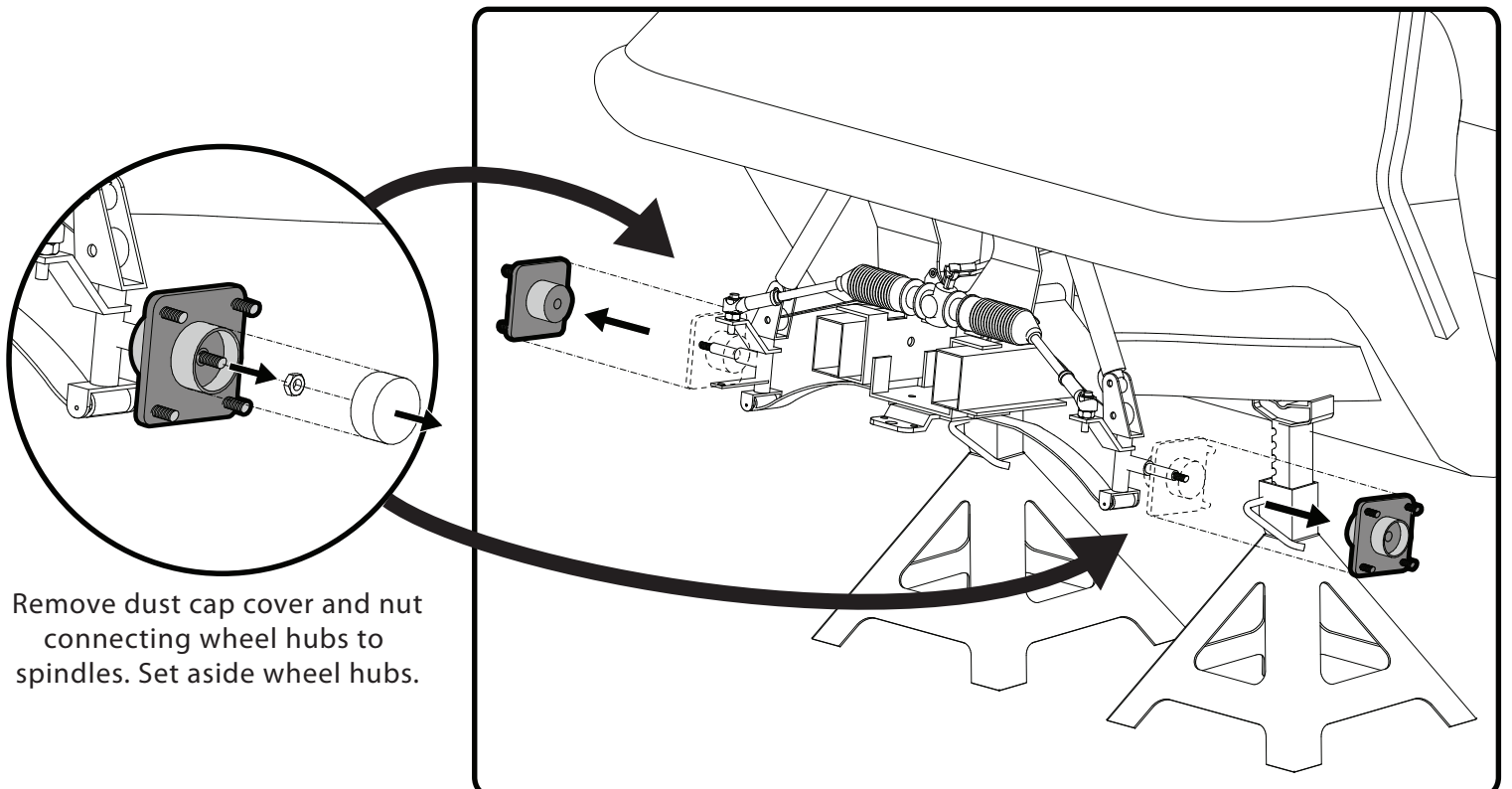

# Installation

Front end disassembly

## 5. Remove steering assembly.

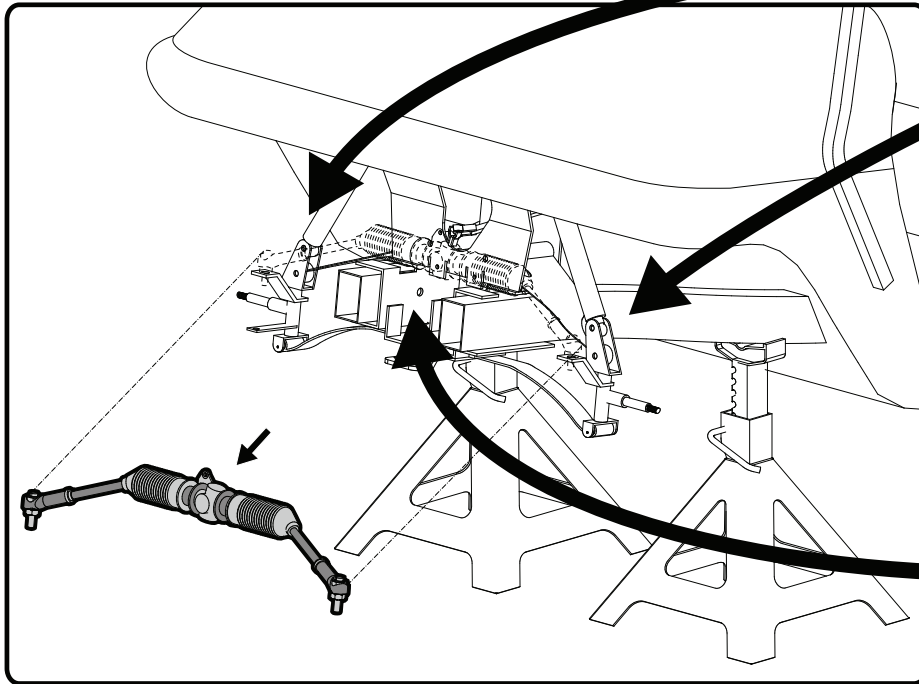

Remove cotter pin and nut connecting tie rods to spindle body.

Remove bolts(3) connecting steering assembly to frame plate. Loosen bolt holding assembly to intermediate shaft.

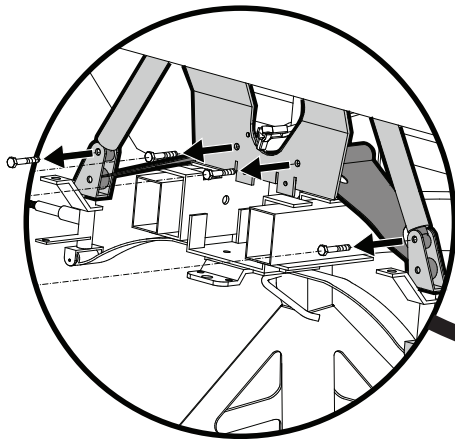

Remove bolts(4) connecting control arms to frame plate and shocks to spindle body.

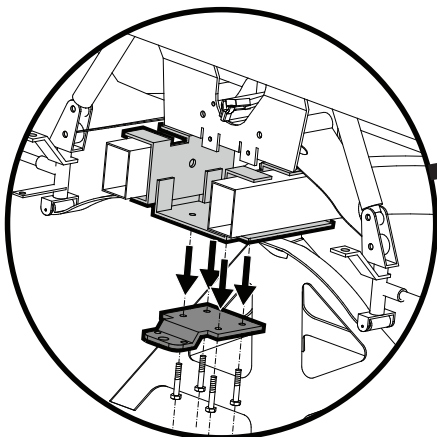

remove bolts(4) connecting lower bracket to rail plate.

## 6. Remove leaf spring/control arm assembly.

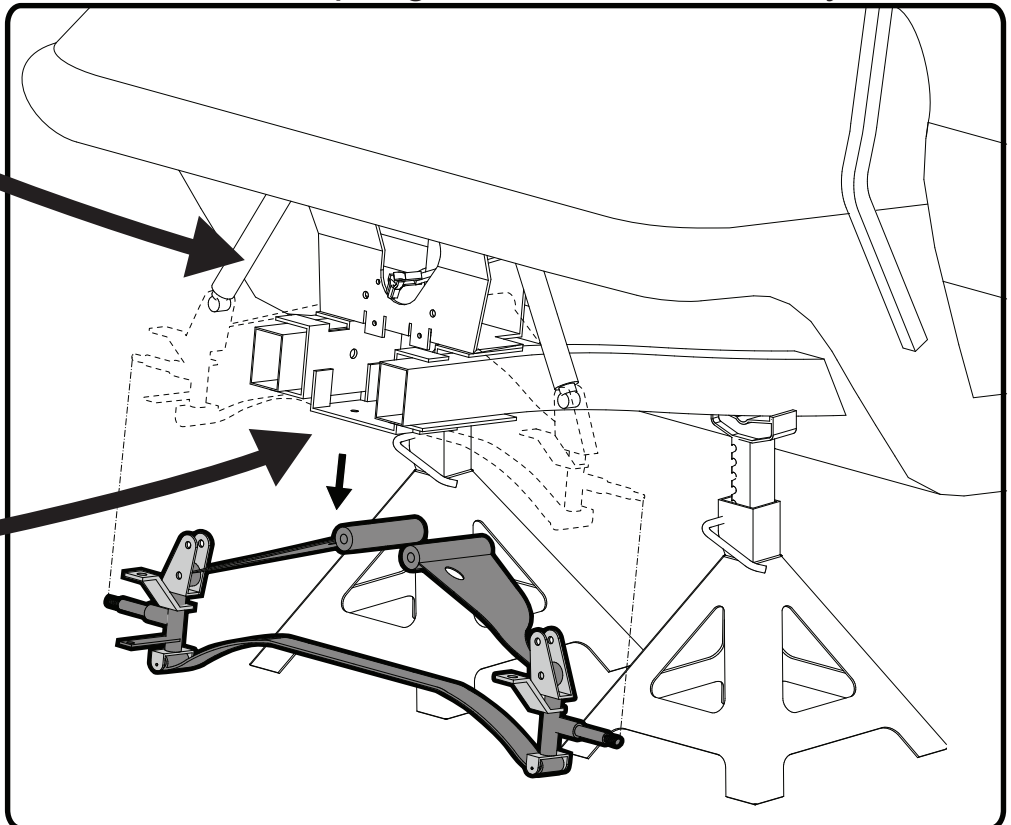



# Installation

Front end assembly

## 7. Install A-arm assembly.

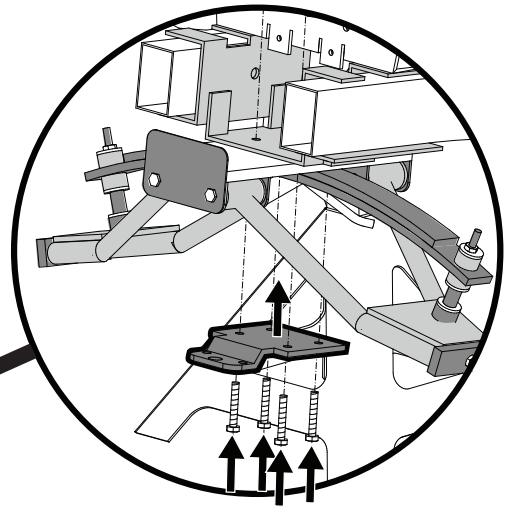
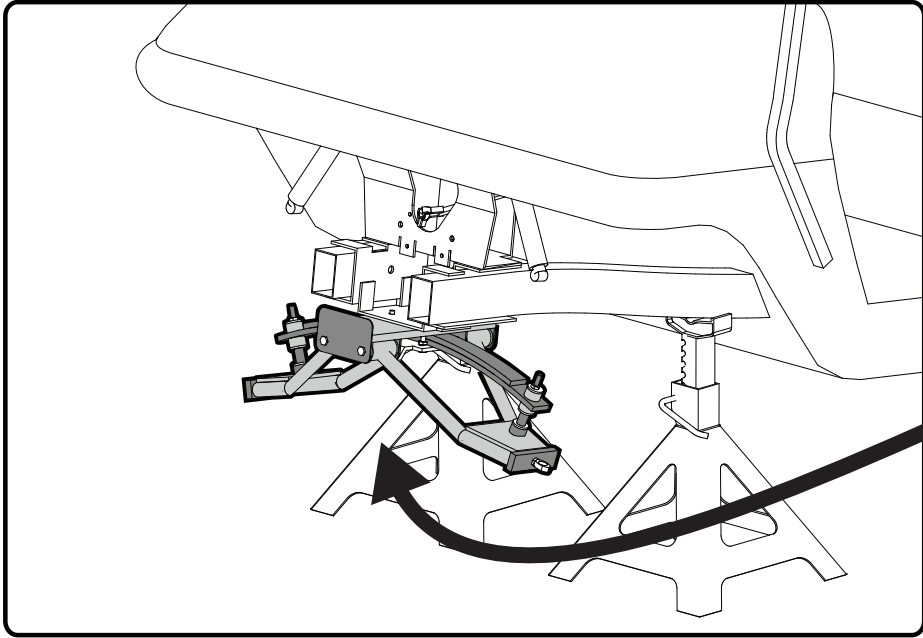

Connect a-arm assembly to frame plate using factory tow plate with supplied carriage bolts.

## 8. Install upper control arms.

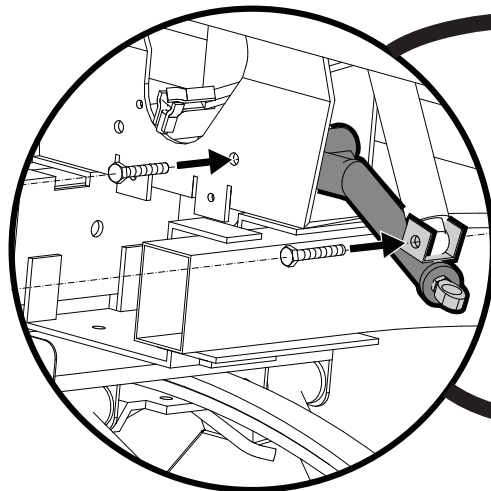

Connect upper control arms to lower shocks and frame plates using supplied bolts.

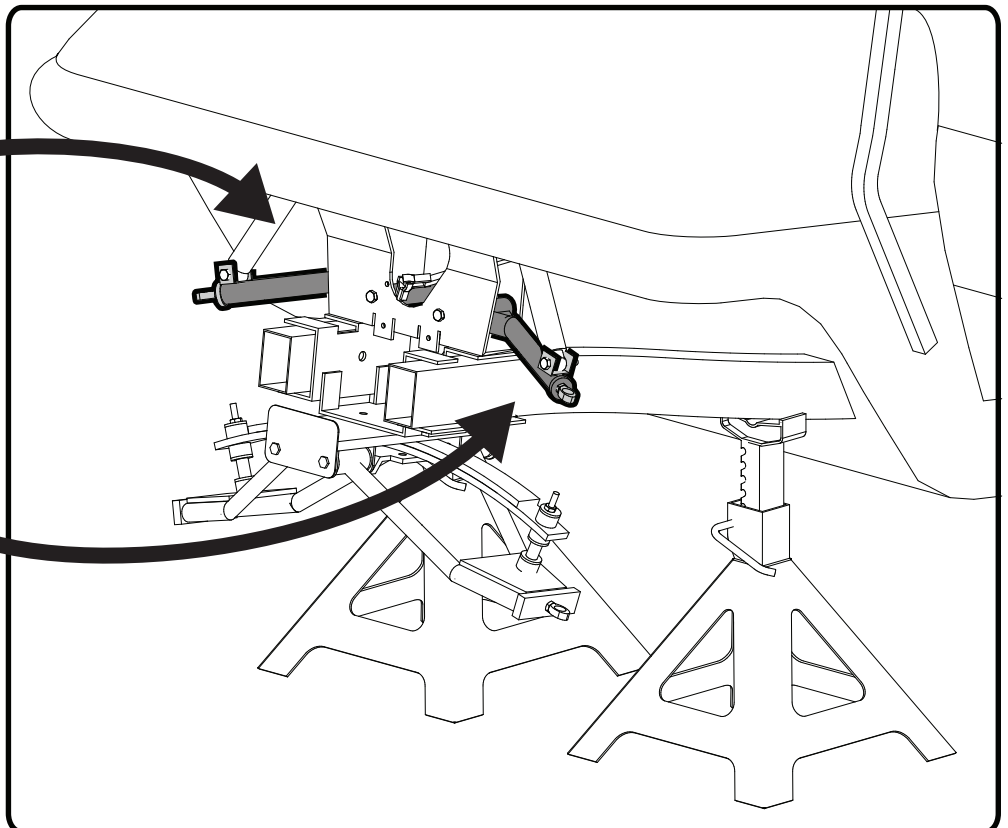

# Installation

Front end assembly

## 9. Re-install steering assembly.

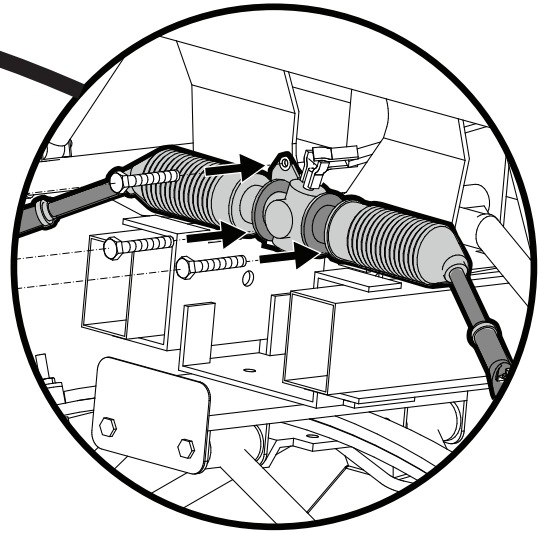
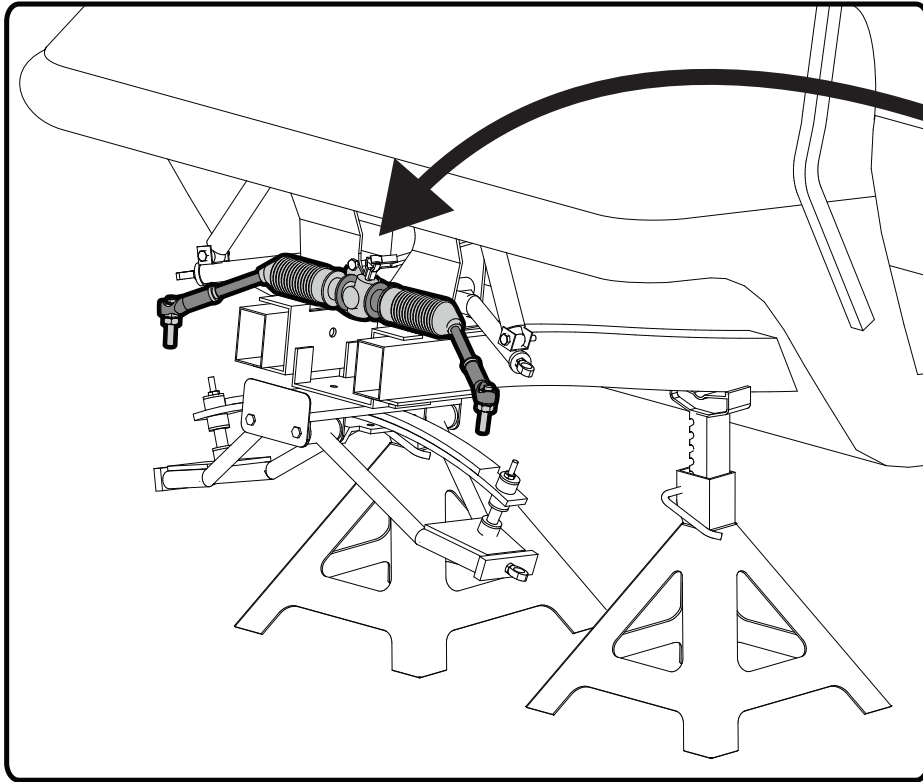

Connect upper control arms to lower shocks and frame plates using supplied bolts.

## 10. Install spindle bodies.

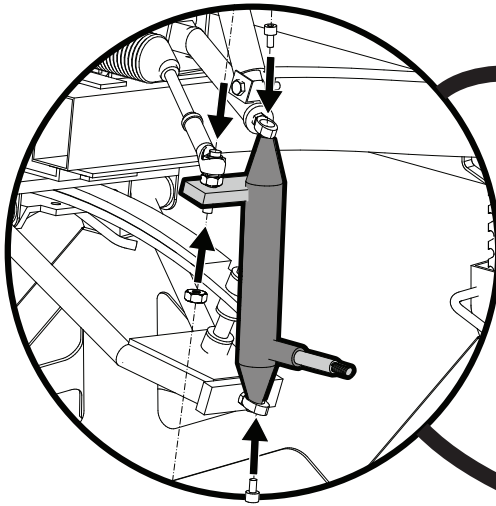

Connect spindle bodies to a-arm assembly and control arm through ball joints with supplied allen bolts.  
connect tie rod ends with factory nuts.

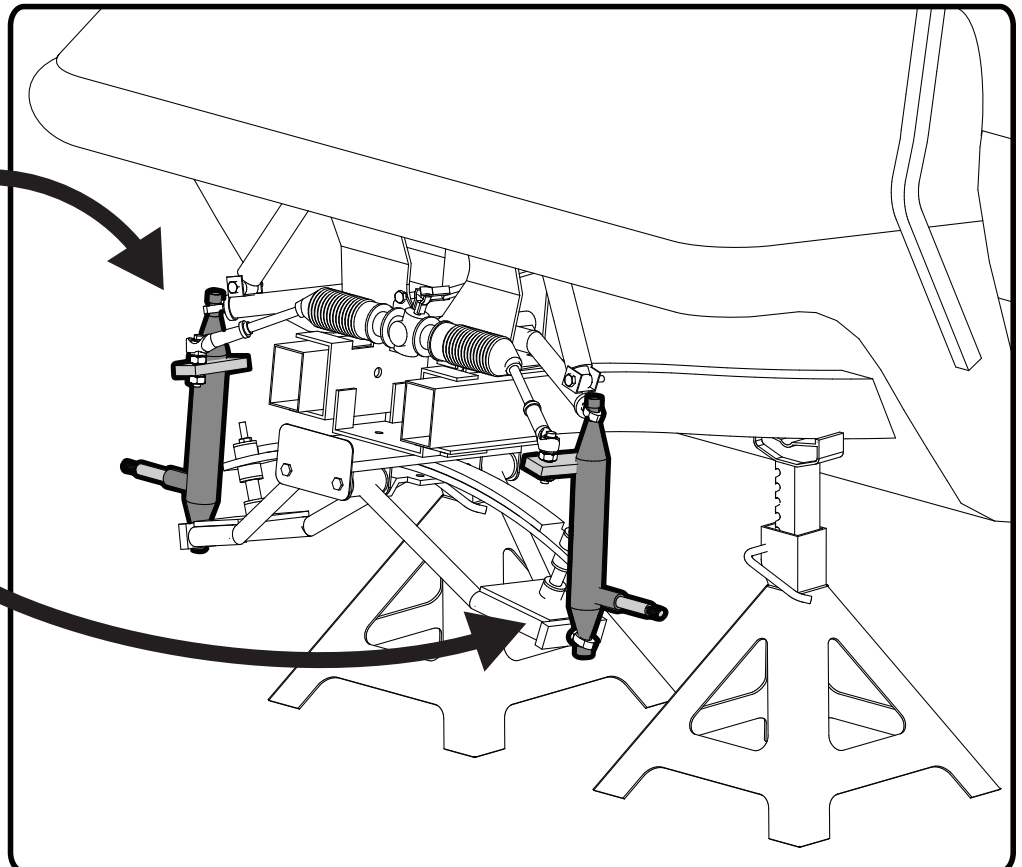

# Installation

Front end assembly

## 11. Re-install wheel hubs.

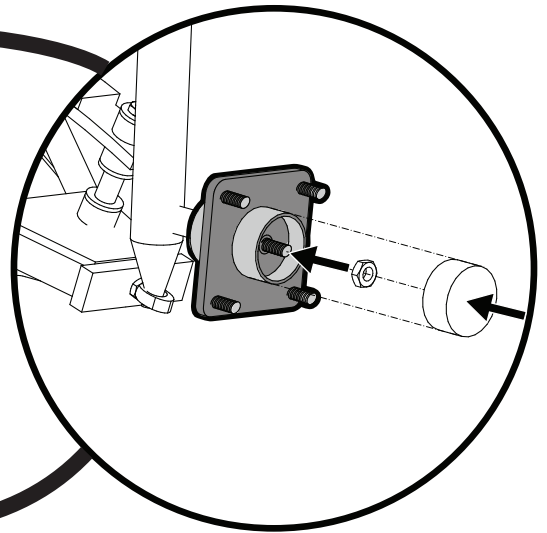
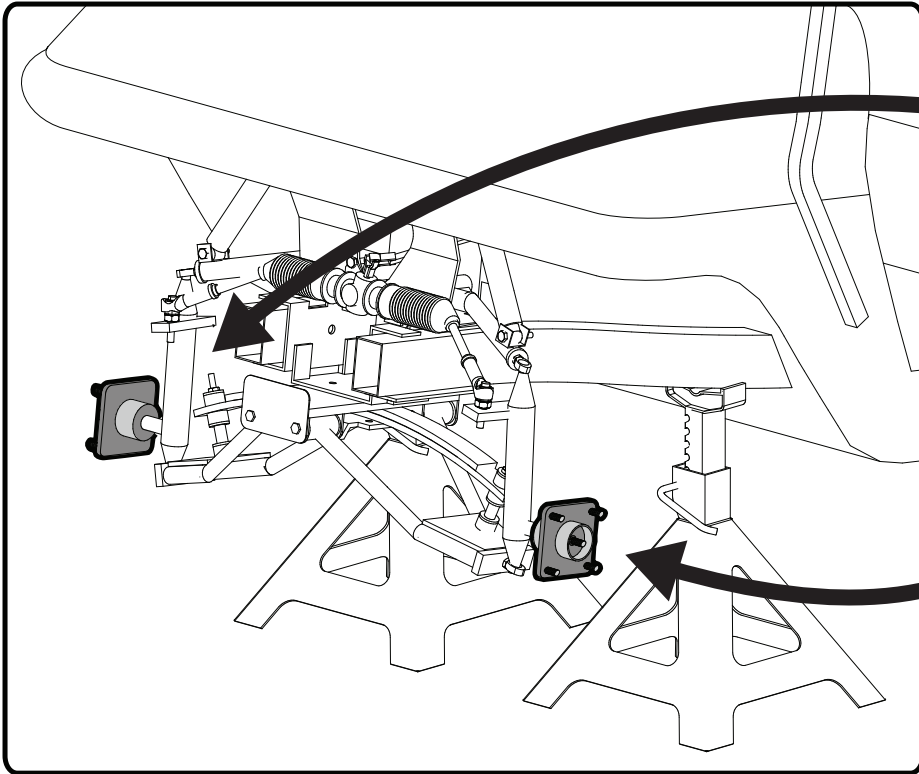

Connect factory wheel hubs to spindle bodies using factory nuts and dust covers.

## 12. Re-install wheels and lower cart.

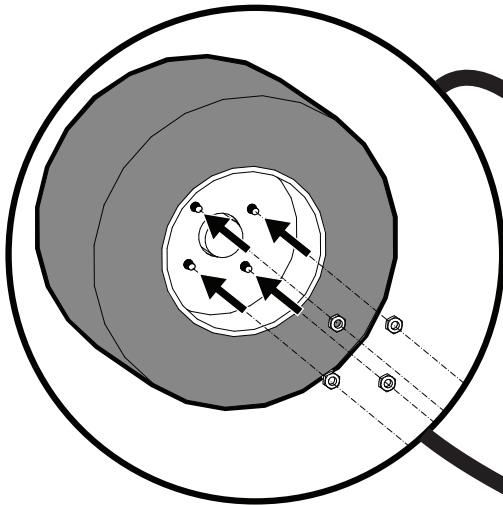
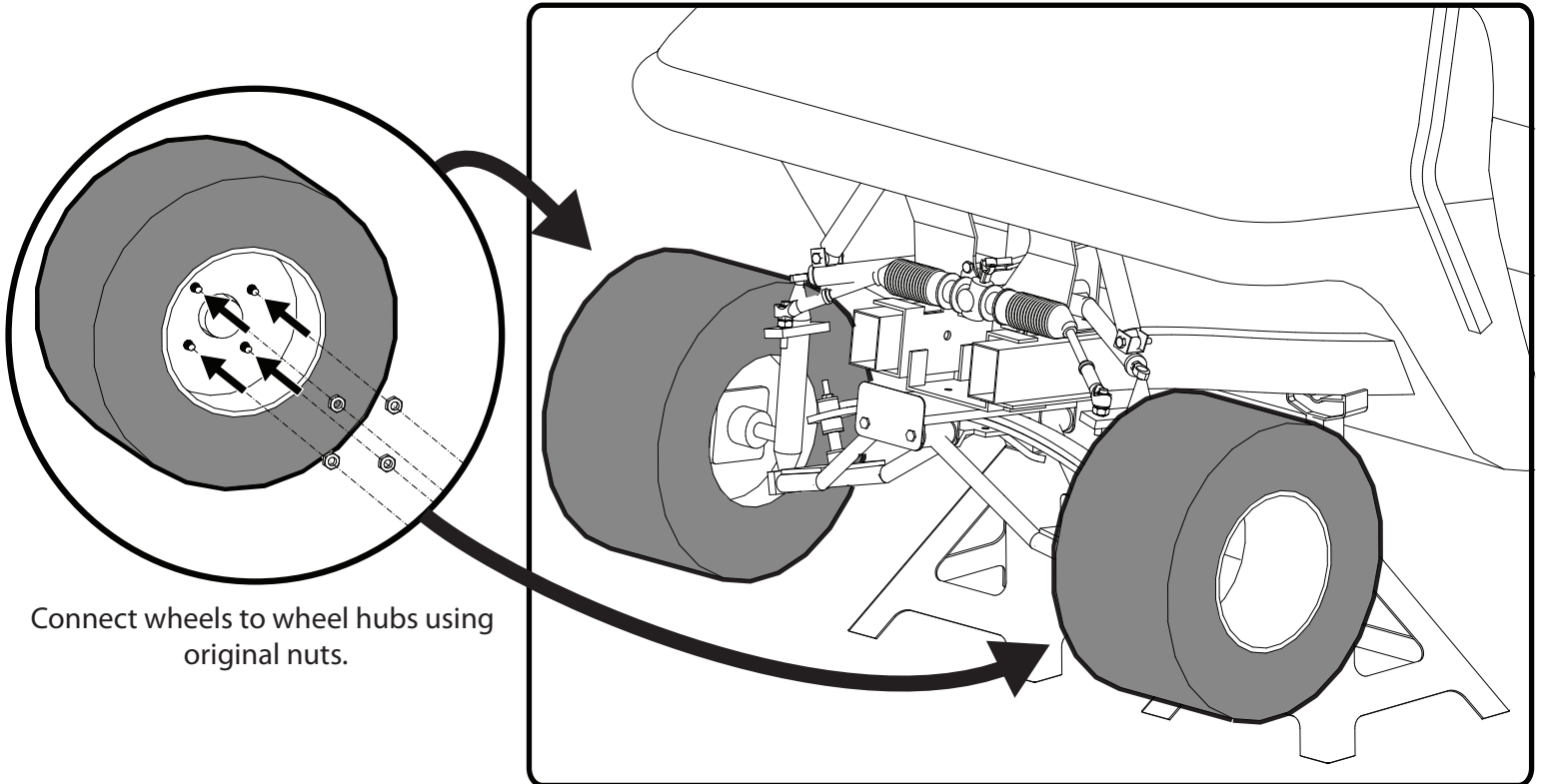

Connect wheels to wheel hubs using original nuts.



# Installation

Rear end assembly

## 4" & 6" A-ARM

13.a. Raise rear end and support frame.

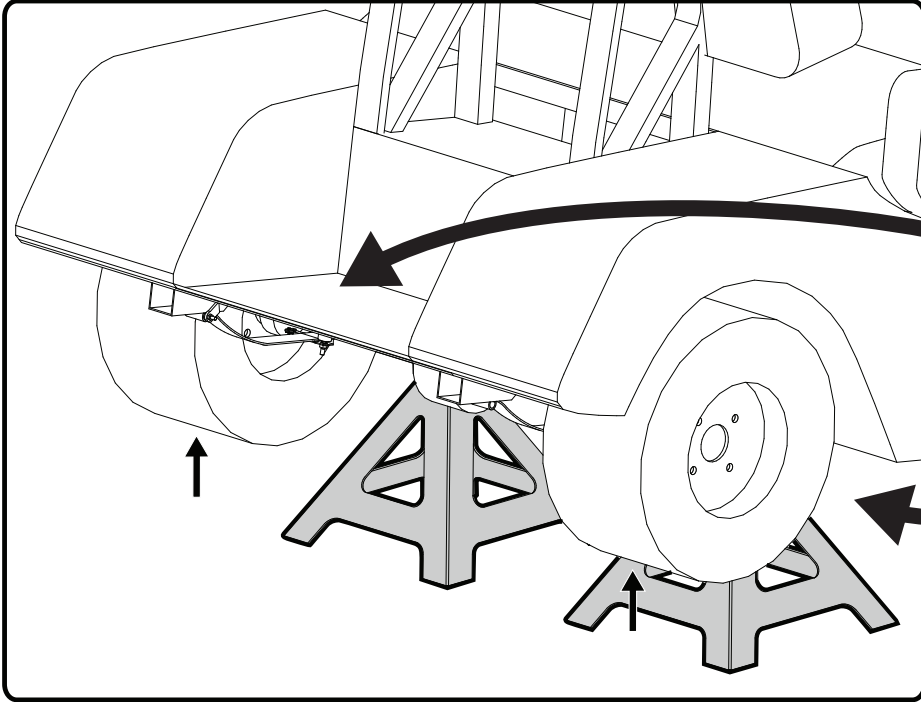

Support frame rails with jack stands and raise until rear wheels are clear of the ground.

14.a. Disconnect shocks and cables.

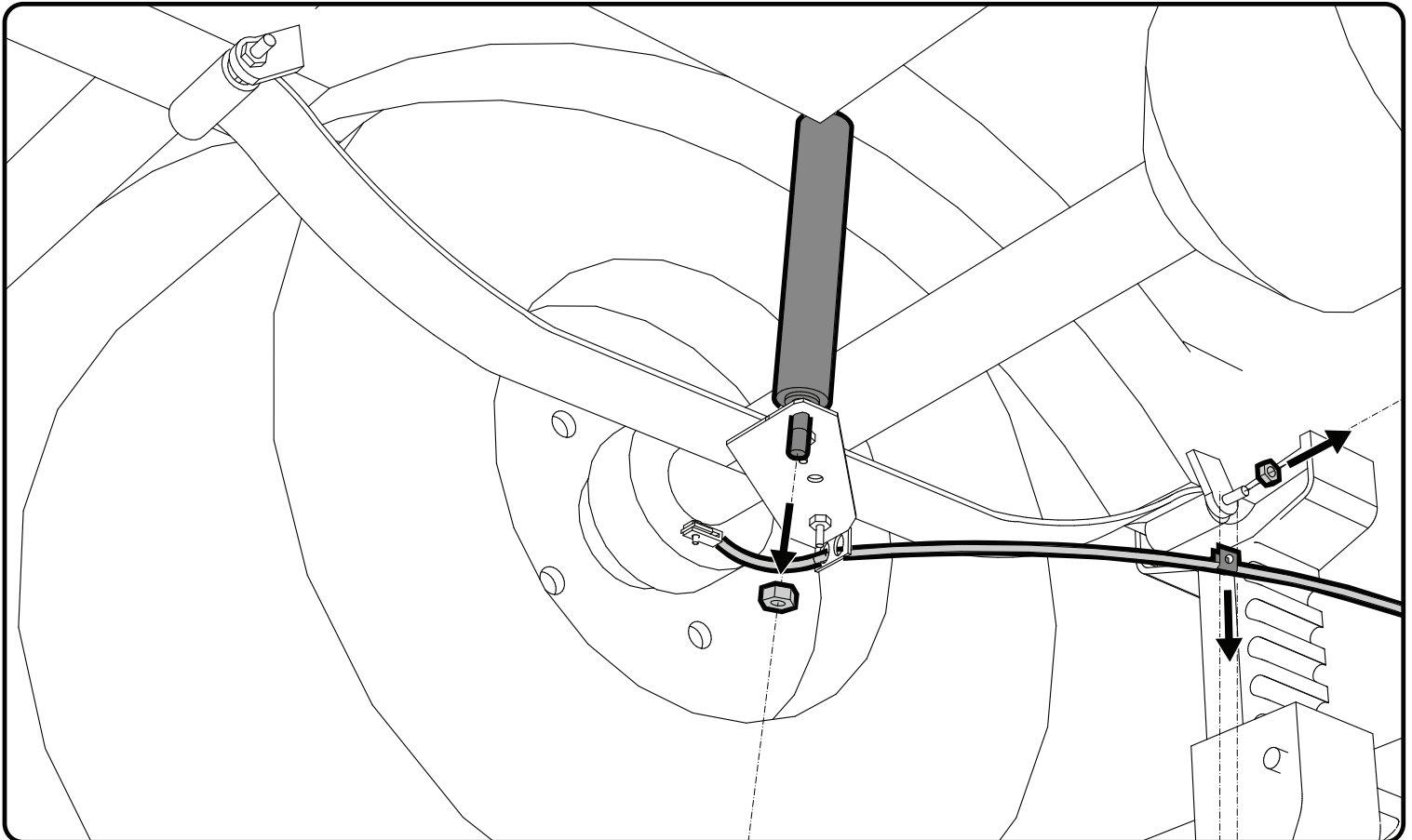

Remove bolt connecting shock to factory shock-plate. Remove bolt connecting brake cable clip to frame.

# Installation

Rear end assembly

## 4" & 6" A-ARM

### 15.a. Remove U-bolt and shock plate.

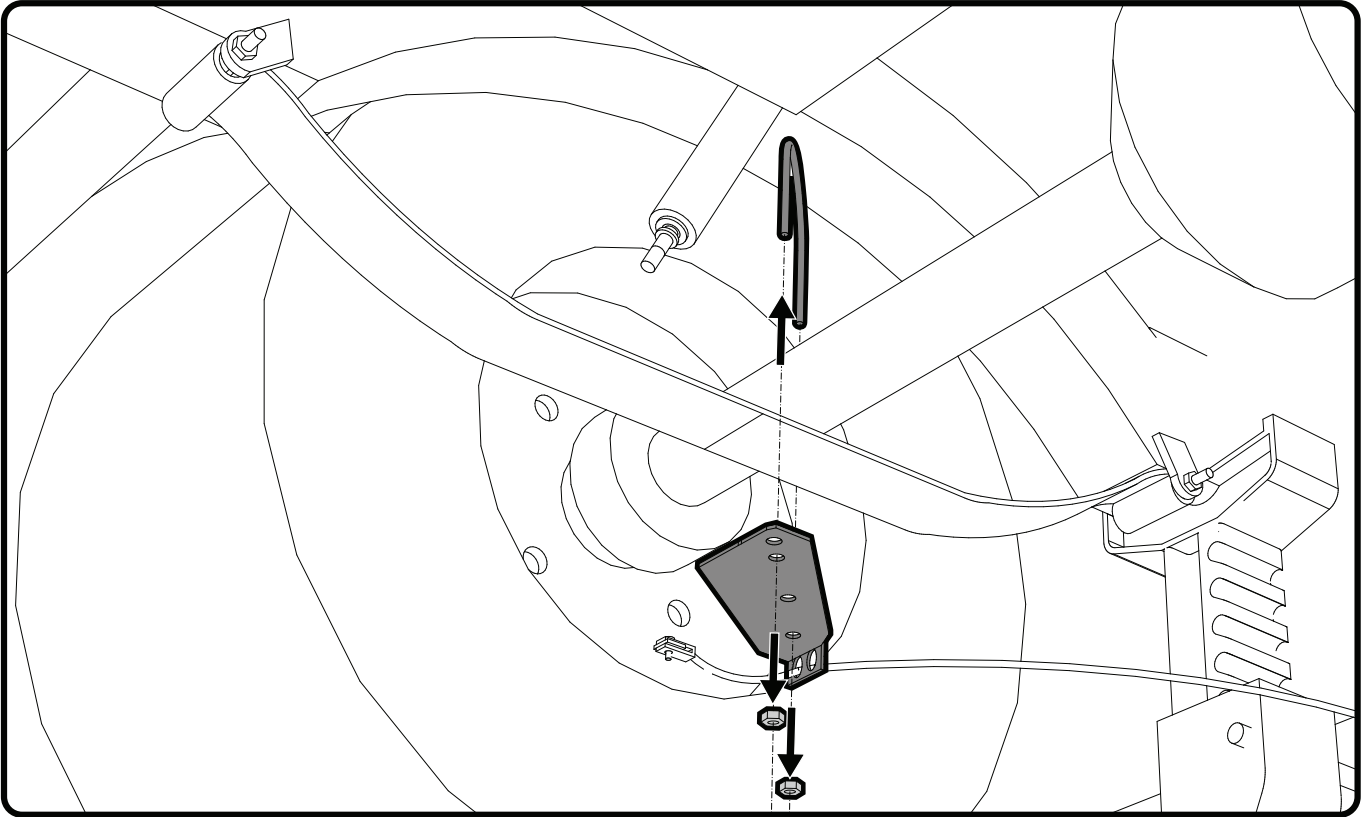

Remove nuts connecting u-bolt to shock mount plate, and remove u-bolt and shock mount plate.  
DO NOT remove brake cable from shock plate.

### 16.a. Raise axle and remove leaf spring.

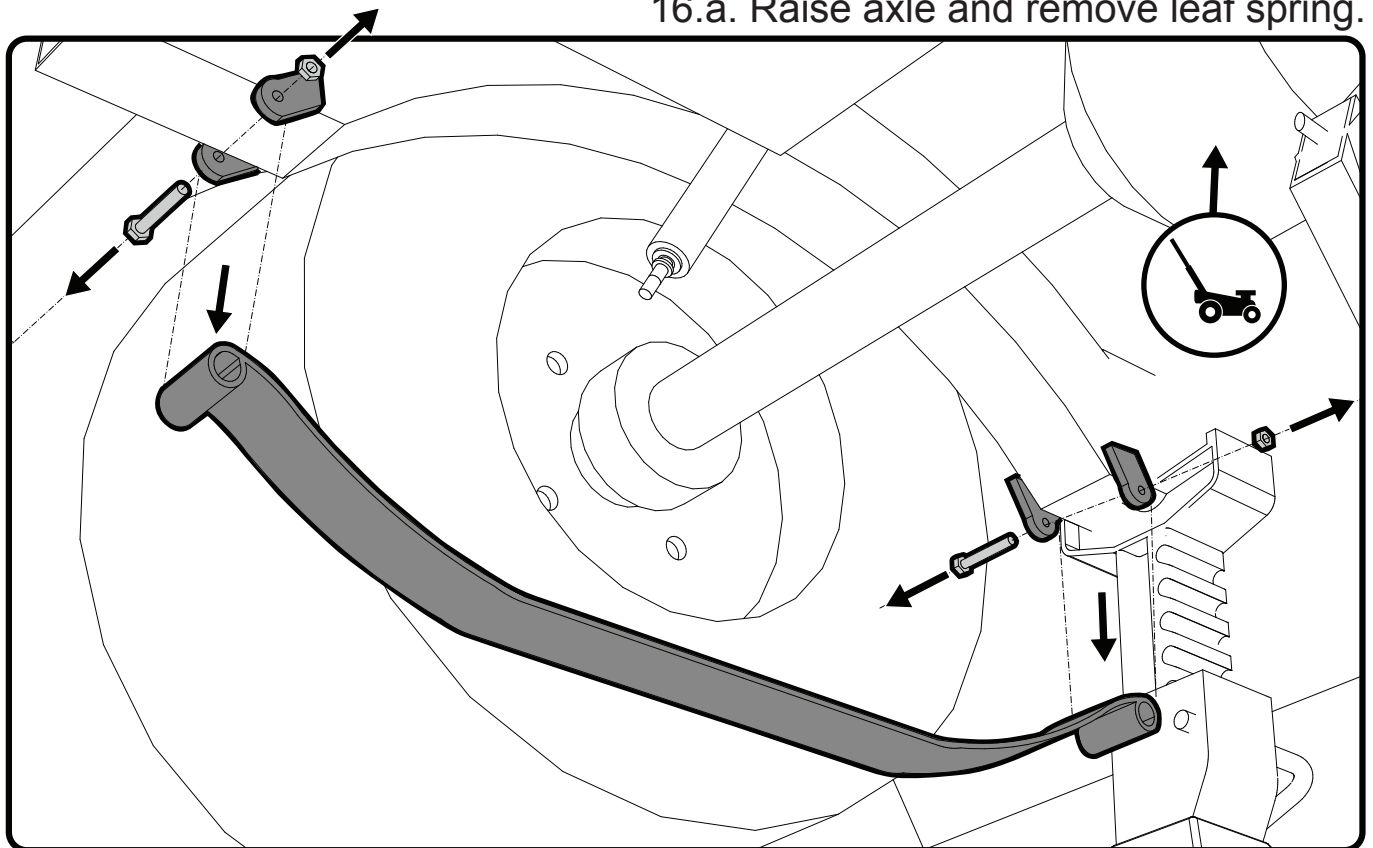

Use a floor jack to raise axle off of leaf spring. Remove bolts connecting leaf springs to frame rails.  
Remove leaf spring.

# Installation

Rear end assembly

## 4" & 6" A-ARM

### 17.a. Lower axle and re-install leaf spring.

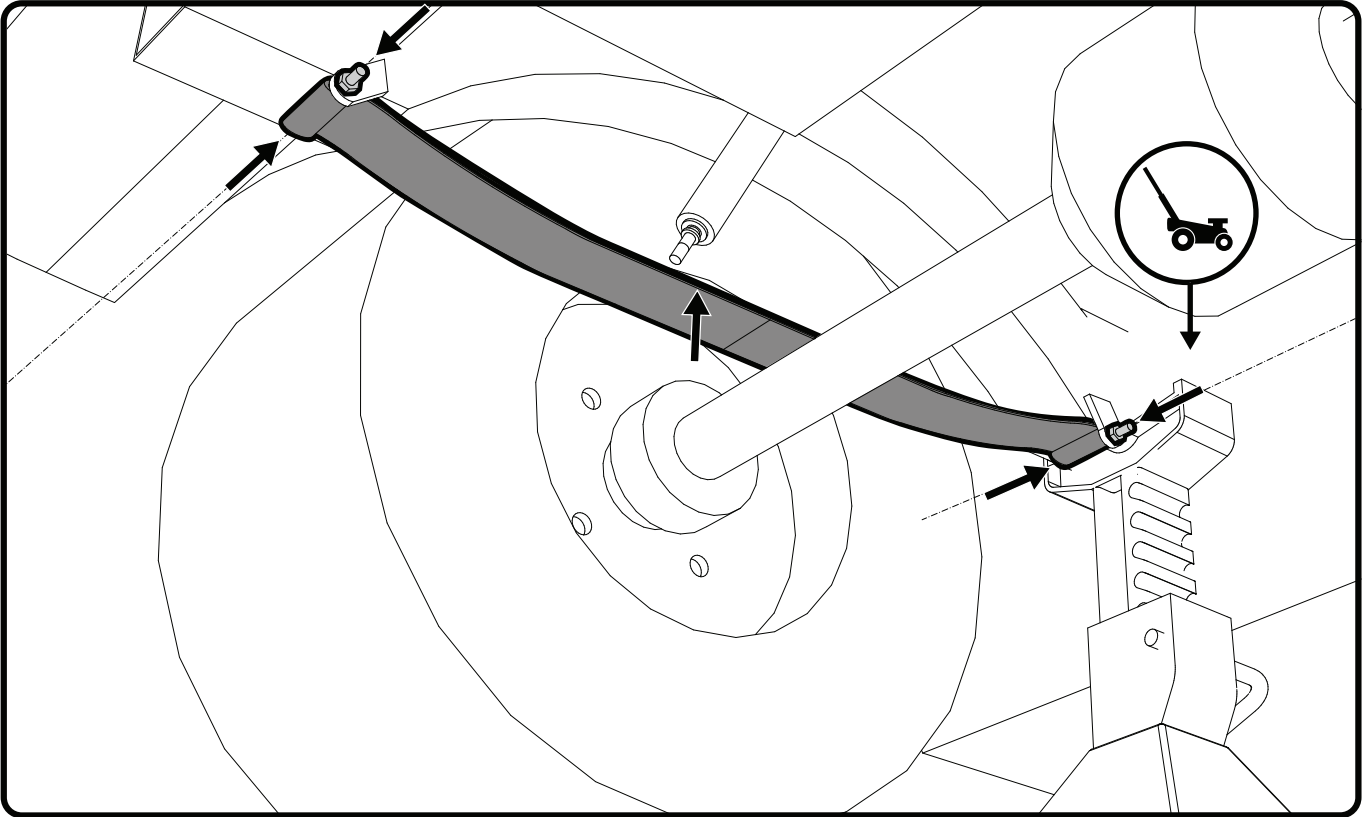

Lower axle on floor jack. Re-bolt leaf spring to frame, positioned above the axle.

### 18.a. Install U-Bolt and Plate Assembly.

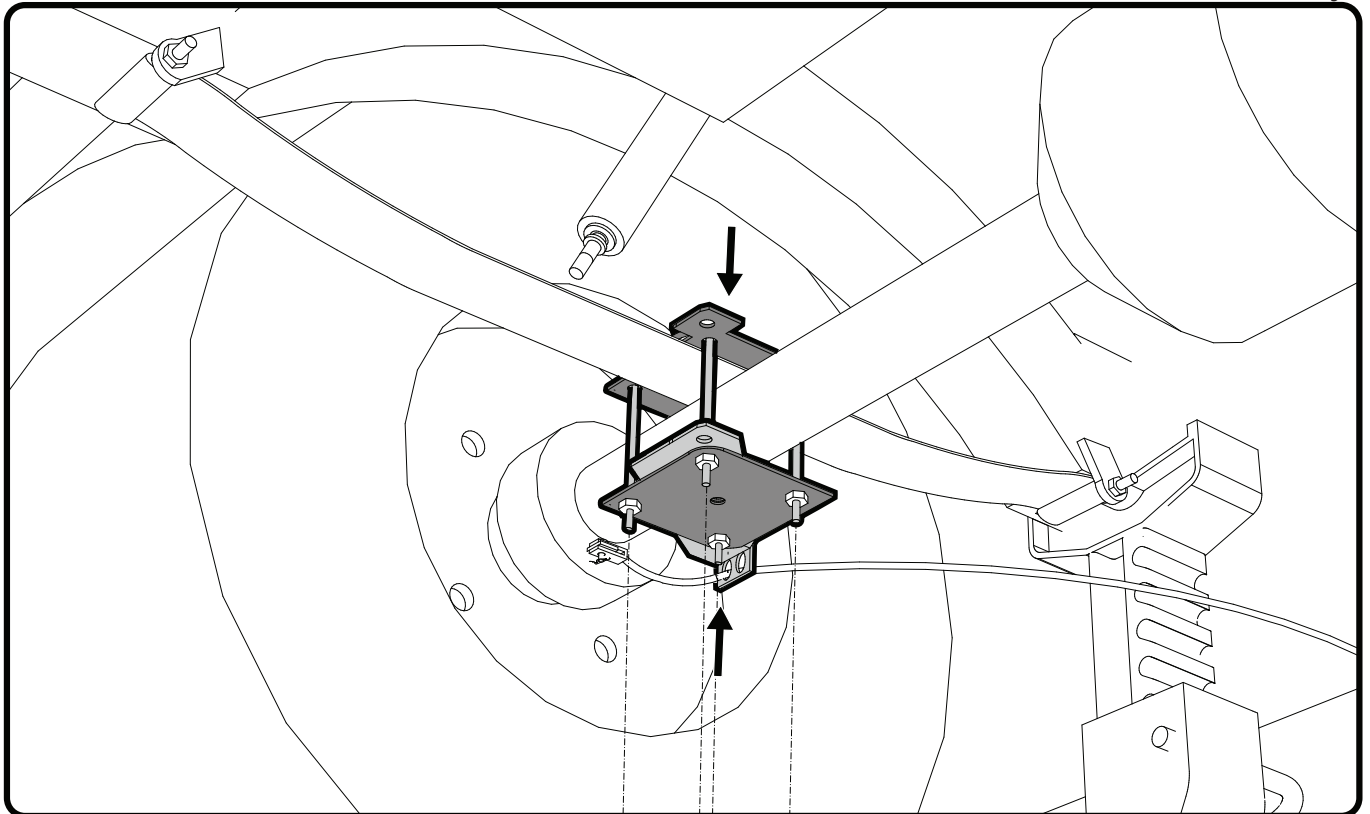

Install new U-bolts(2) and new 6-hole shock mount plate on top of leaf spring.  
Install original shock mount/brake cable plate and new bottom 5-hole plate onto U-bolts.  
Start nuts on U-bolts, but DO NOT tighten until next step.

# Installation Rear end assembly 4" & 6" A-ARM

## 19.a. Install Axle Seat.

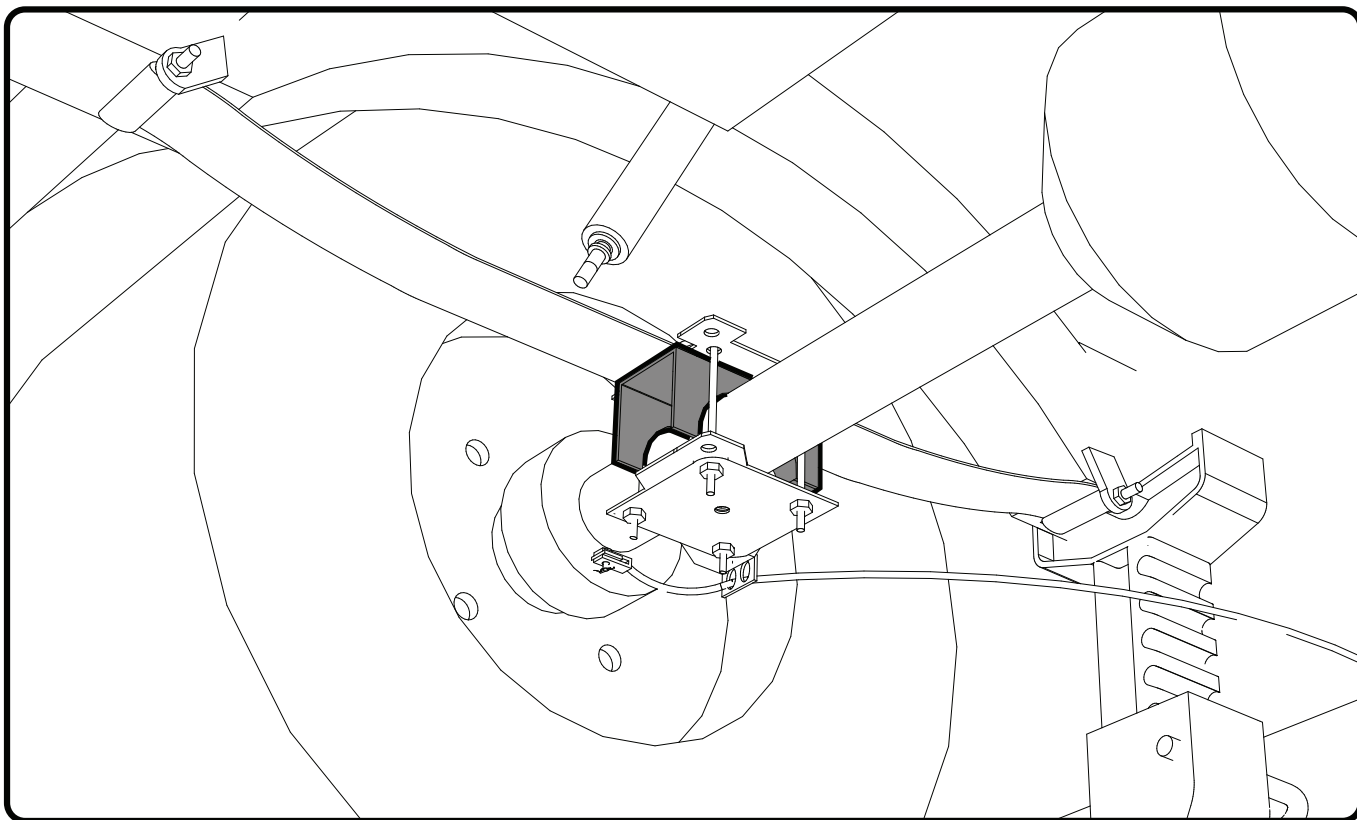

Install axle seat between axle and leaf spring and tighten u-bolt nuts to secure assembly.  
Repeat steps 14.a -19.a for the opposite side of the axle.

## 20.a. Attach shocks to new shock mount.

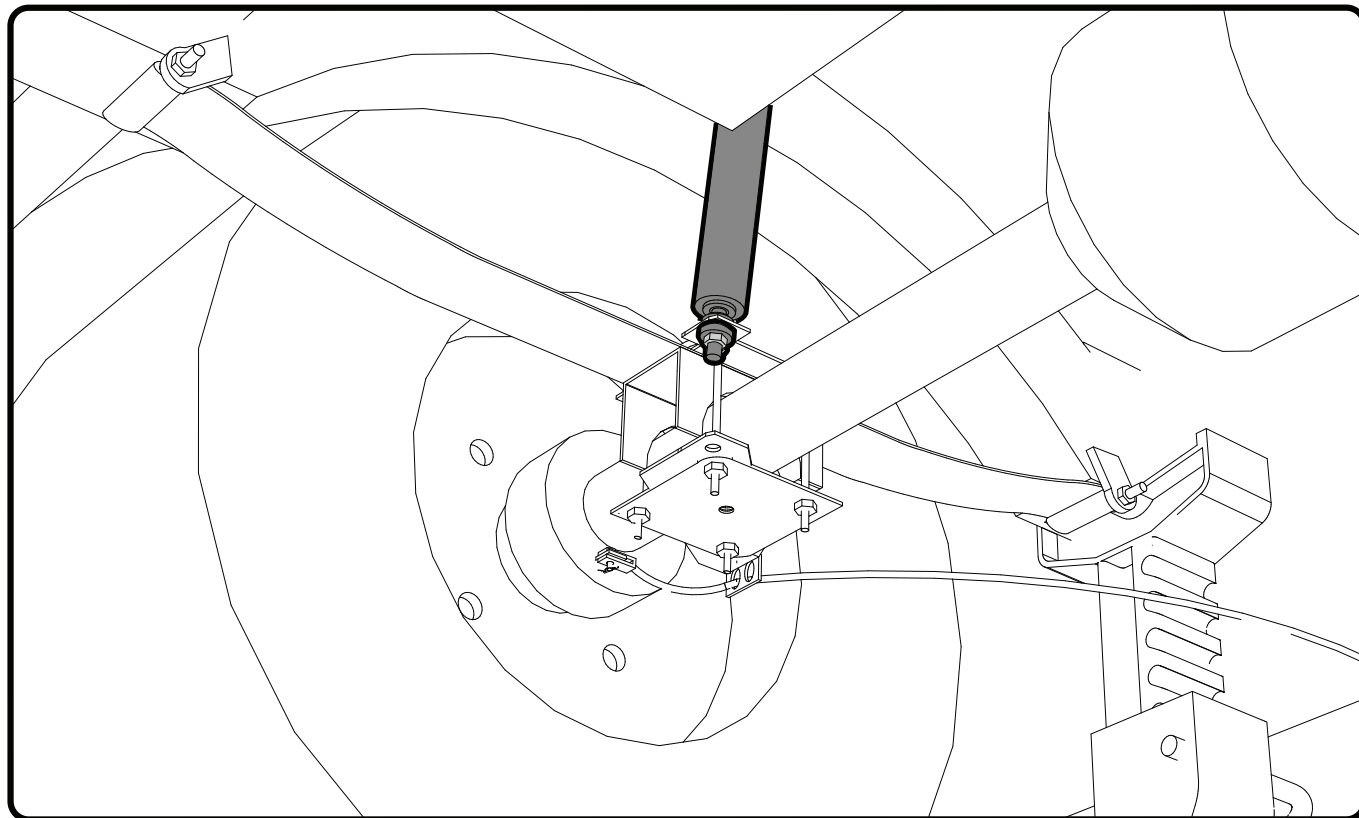

AFTER repeating steps 14.a -19.a for both sides of the axle, re-attach shocks to new shock mount plates.  
Lower cart and enjoy!

# Installation Rear end assembly

## 3" A-ARM

13.b. Raise rear end and support frame.

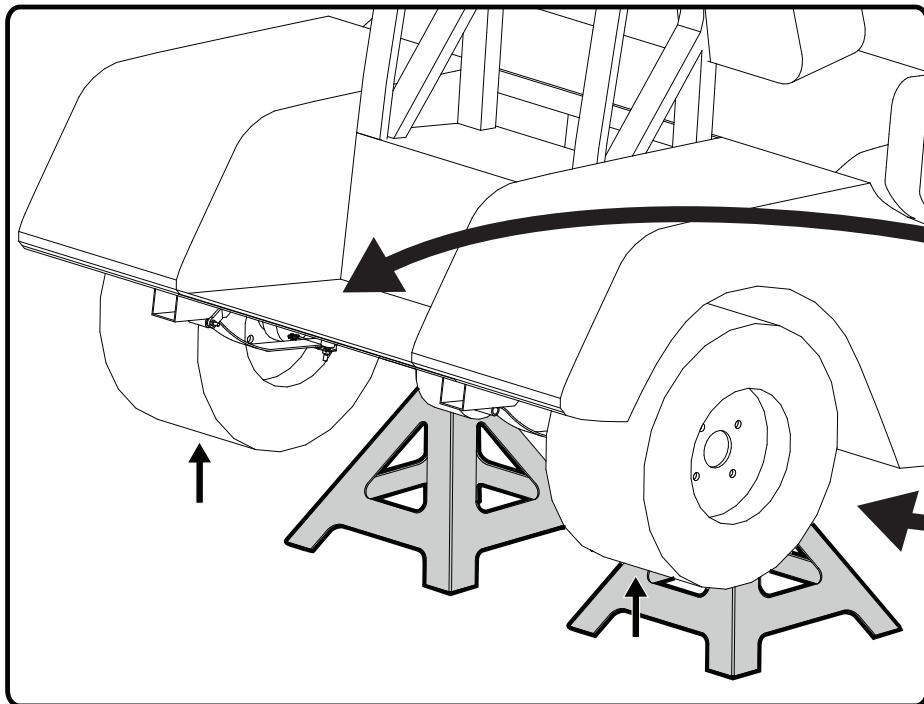

Support frame rails with jack stands and raise until rear wheels are clear of the ground.

14.b. Disconnect shocks and cables.

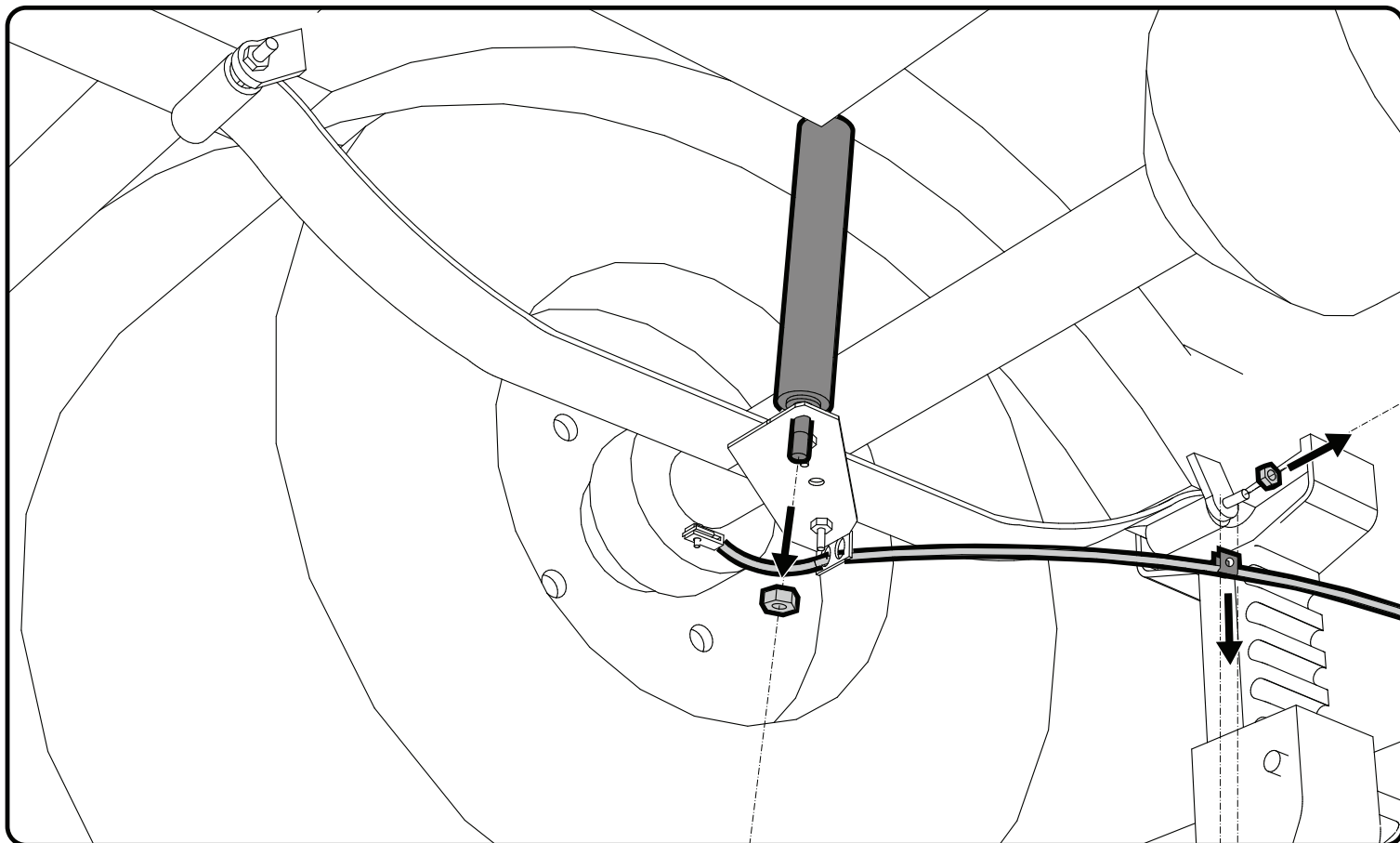

Remove bolt connecting shock to factory shock-plate. Remove bolt connecting brake cable clip to frame.



# Installation Rear end assembly

## 3" A-ARM

15.b. Support axle and unbolt leaf spring.

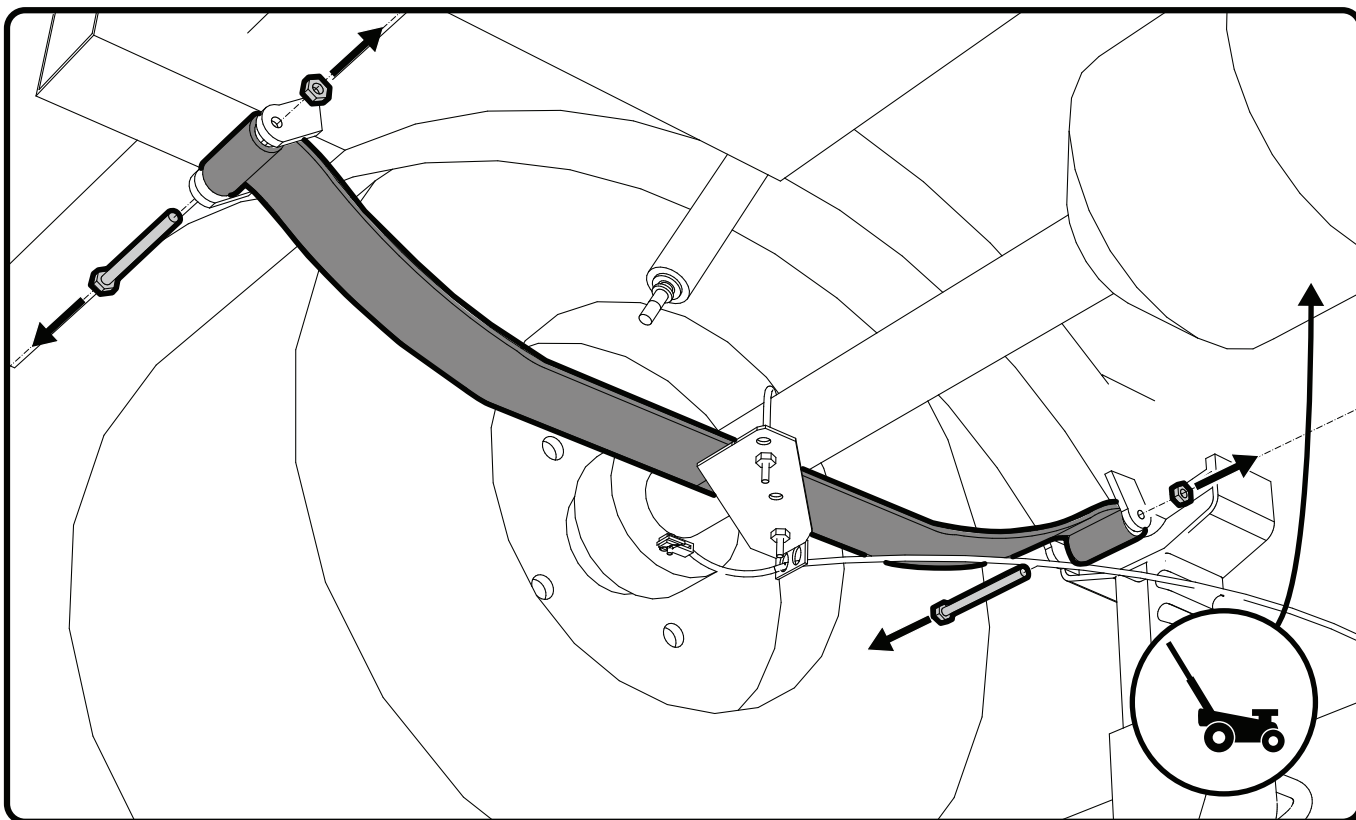

Use a floor jack to support axle to remove tension from leaf spring.  
Remove bolts connecting leaf spring to frame rail.

16.b. Remove Shackle, Bushing, and Sleeve.

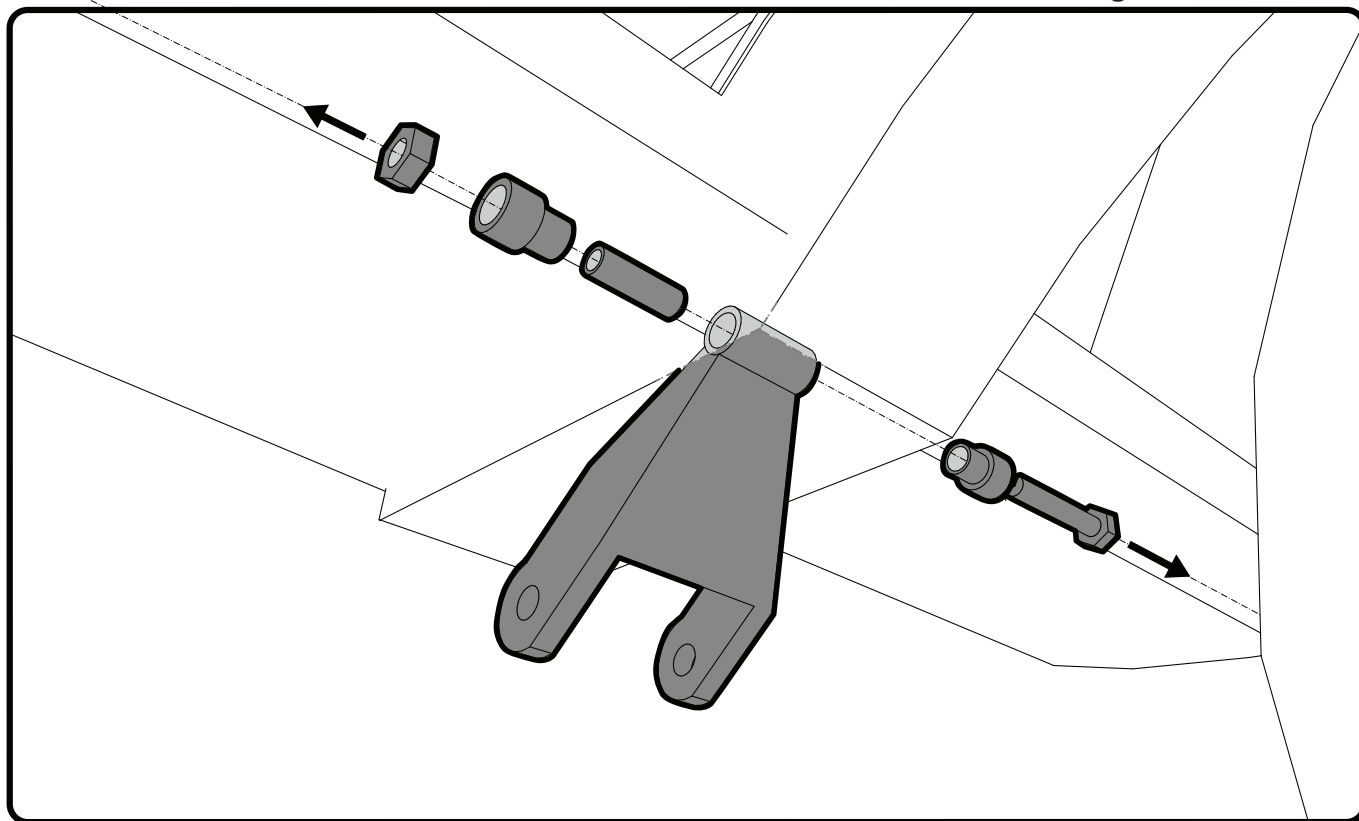

Unbolt shackle from frame. Remove bushing and sleeve and save for next step.

# Installation Rear end assembly

## 3" A-ARM

### 17.b. Lower axle and install shackle extensions.

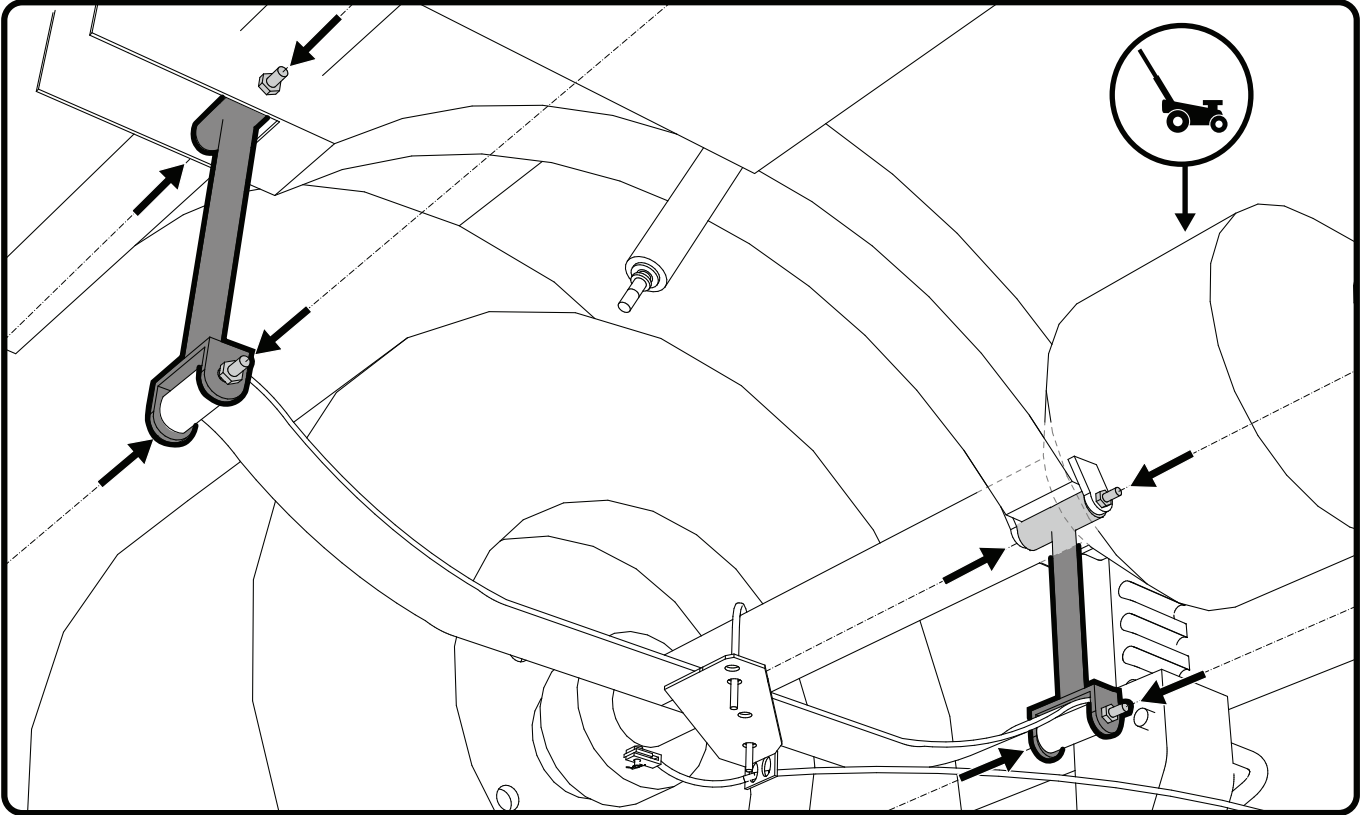

Lower axle on floor jack until there is enough clearance for shackle extensions. Attach shackle extensions to frame using factory hardware. Attach shackle extensions to leaf spring using factory hardware.

Repeat steps 14.b -17.b for other side.

### 18.b. Re-attach shocks.

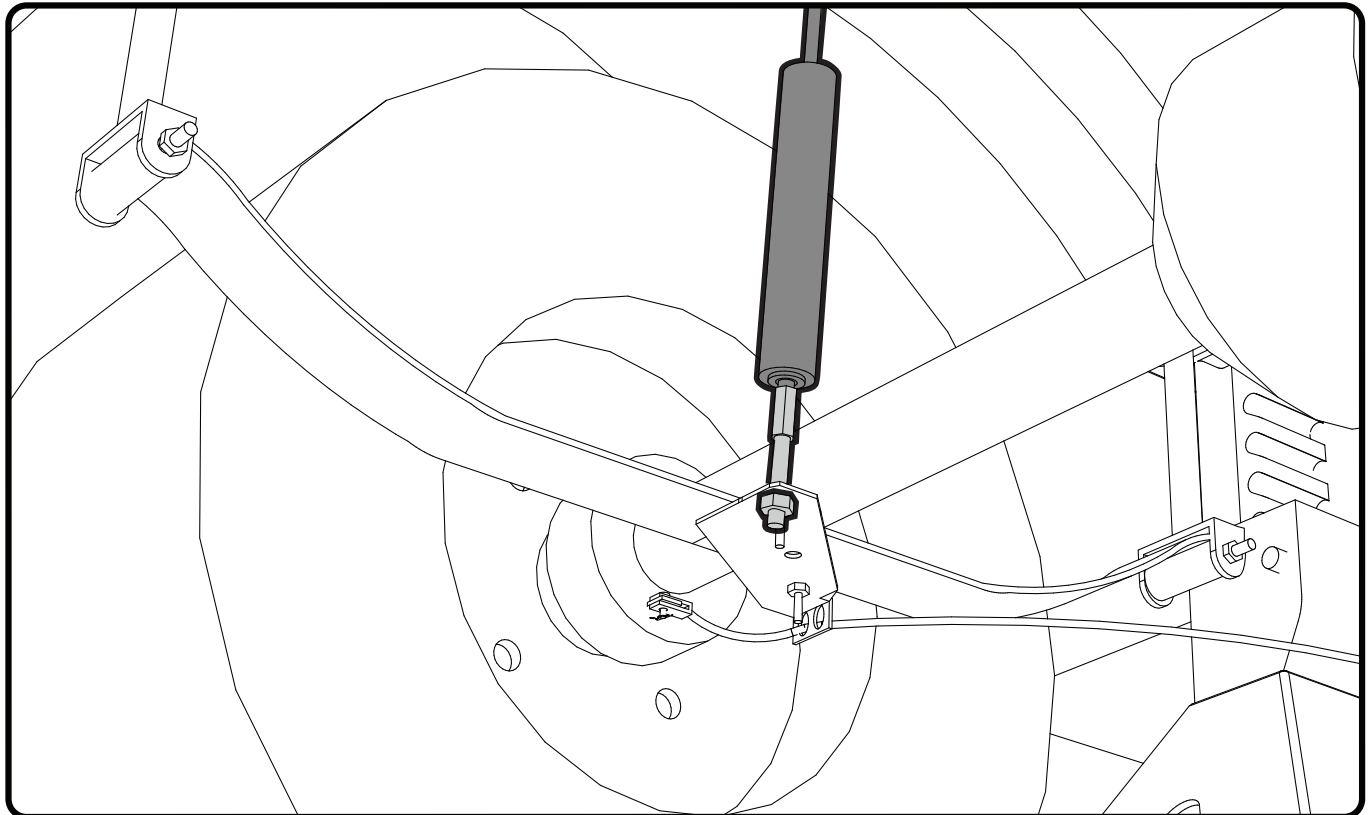

AFTER repeating steps 14.b - 17.b for both sides of the axle, Attach shocks thread extensions to shocks. Re-attach shocks to shock plate. Lower cart and enjoy!