

# Yamaha Drive Rear Flip Seat Kit

instruction manual

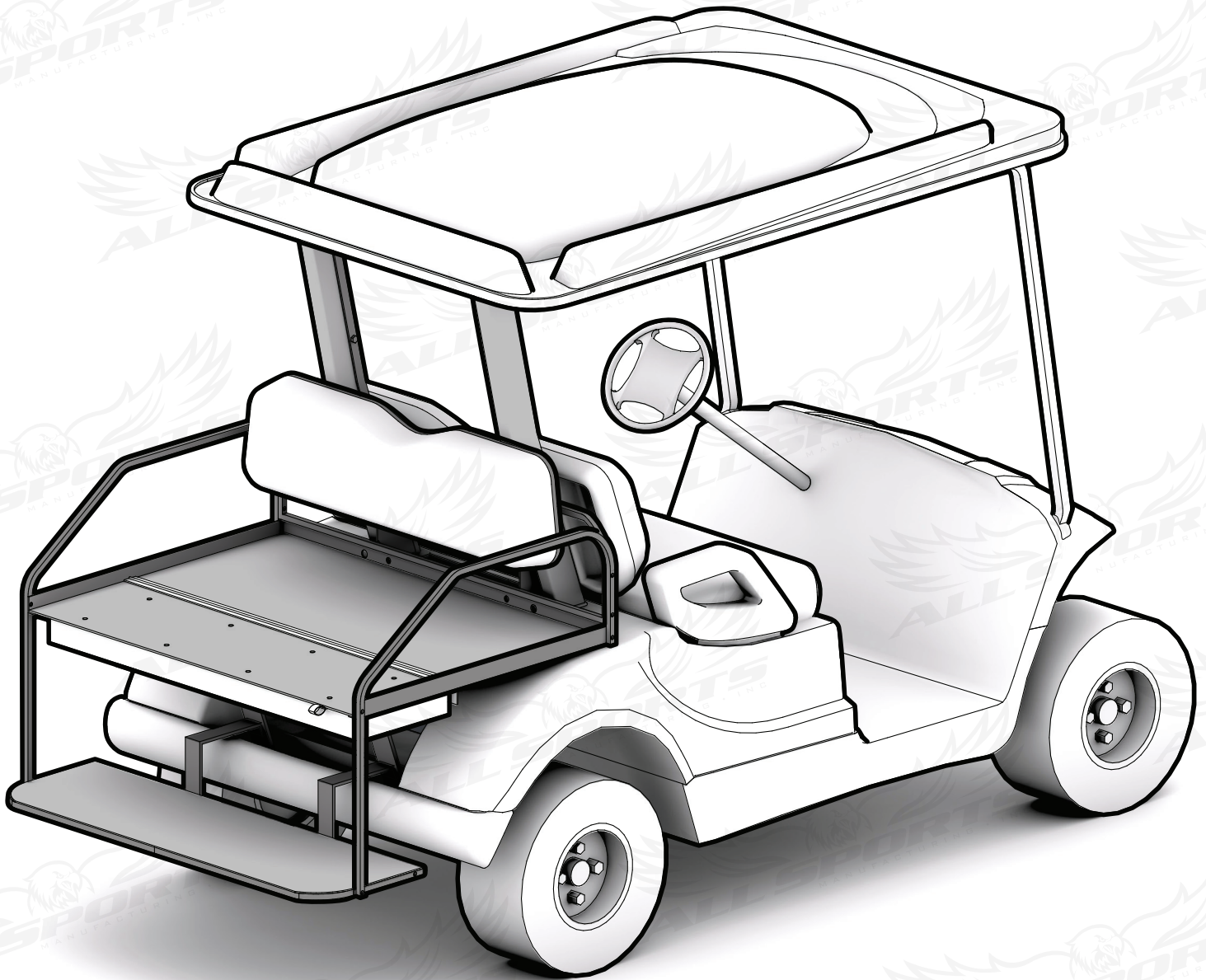

1-866-291-5244

  
**ALL SPORTS**  
MANUFACTURING • INC

# Parts List

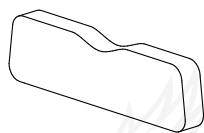

Back Pad (1)

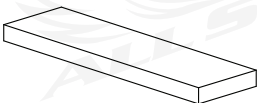

Seat Pad (1)

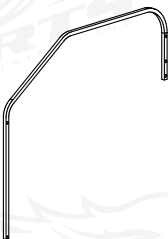

Side Frame (2)

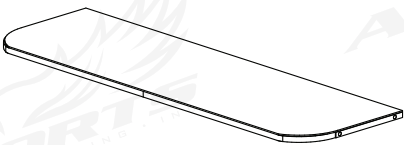

Step Plate (1)

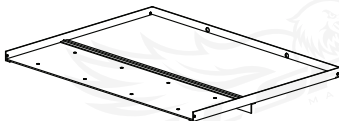

Flip Seat Frame (1)

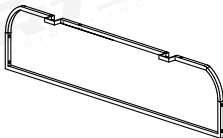

Back Frame (1)



Front Supports(2)

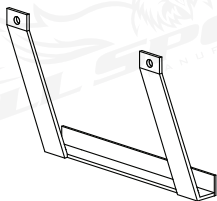

Rear Support



Step Plate  
Supports(2)

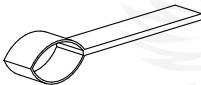

Seat Pull(1)

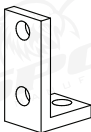

Rear Seat Supports(2)

## Bolts

Hex 1" x 1/4"  
(8)



1/4" x 1"  
(4)



1/4" x 1 3/4"  
(6)



1/4" x 3 1/2"  
(2)



5/16" x 1"  
(6)



5/16" x 1 1/2"  
(6)



5/16" x 2"  
(2)



5/16" x 2 1/2"  
(6)



1/4" Washer  
(16)



5/16" Washer  
(40)

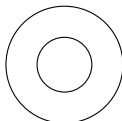

1/4" Nyloc Nut  
(8)



5/16" Nyloc Nut  
(18)



5/16" Acorn Nut  
(2)



\*Parts not shown in proportion.

# Installation

## 1. Unbolt Supports.

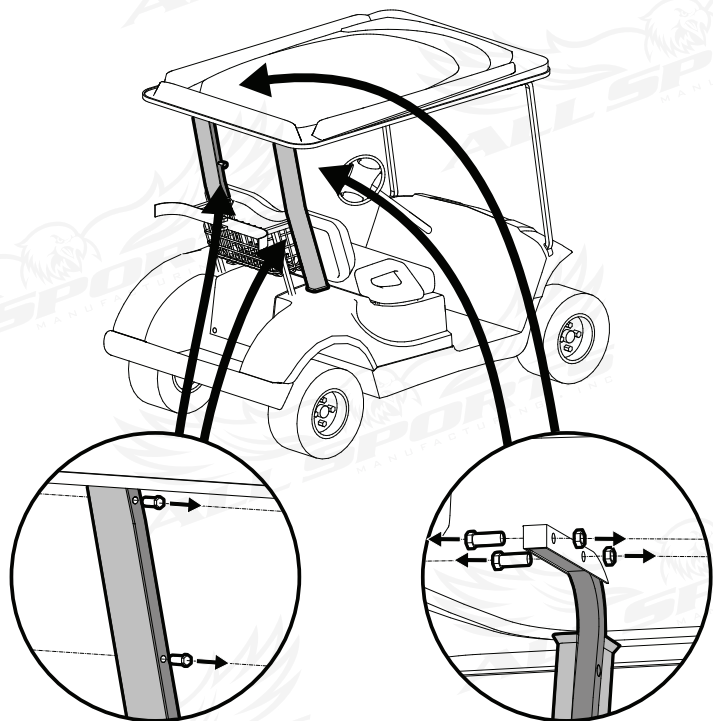

Remove bolts connecting gutters to roof supports.

Remove bolts connecting roof supports to roof.

## 2. Remove gutters and roof supports.

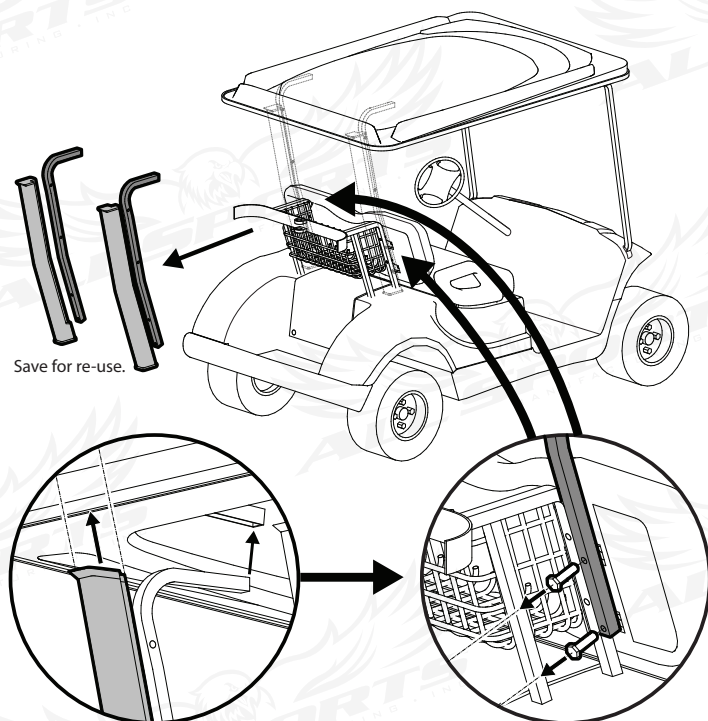

Save for re-use.

Raise roof and remove gutters by sliding upwards.

Remove bolts connecting roof supports to bag holder.

## 3. Remove seat cushion and access panel.

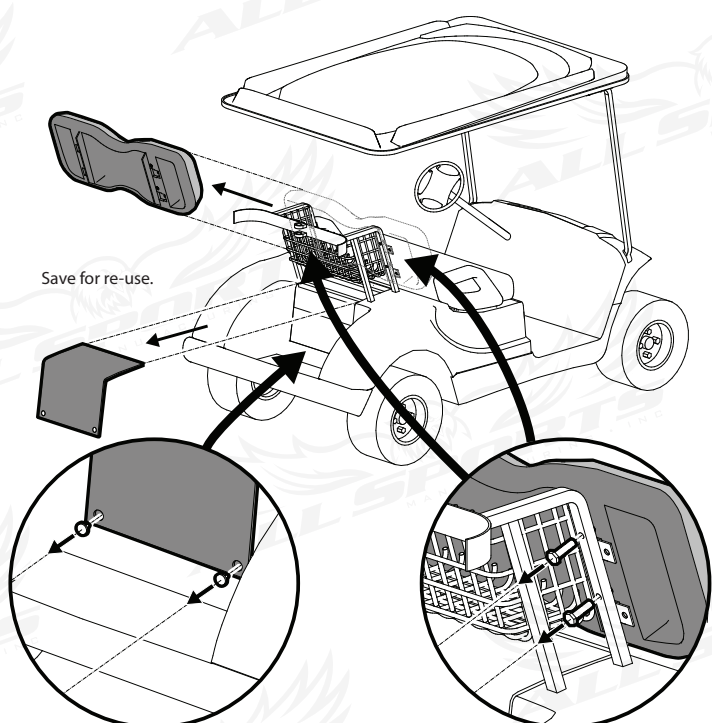

Save for re-use.

Remove rivets connecting access panel to body.

Remove bolts connecting seat cushion to bag holder.

## 4. Remove bag holder.

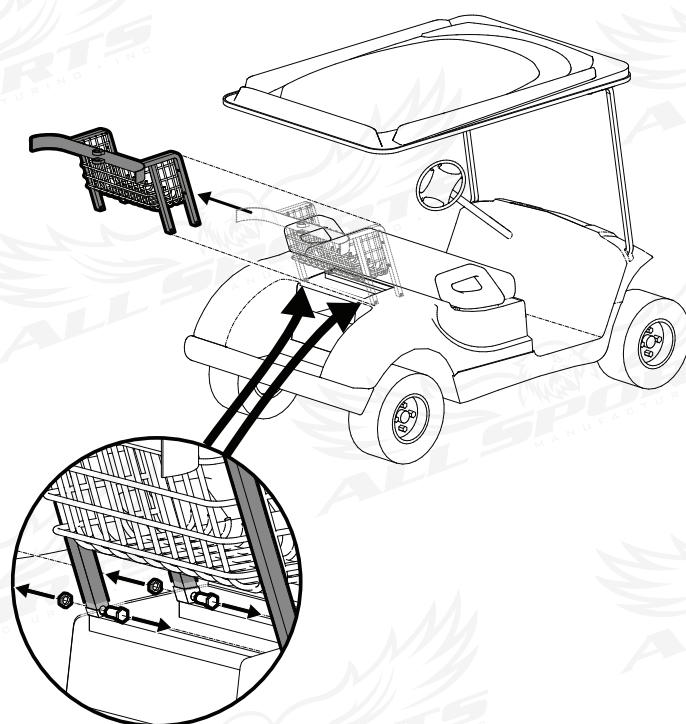

Remove bolts connecting bag holder to horizontal frame bars located underneath the body.



# Installation

## 5. Install frame supports and access panel.

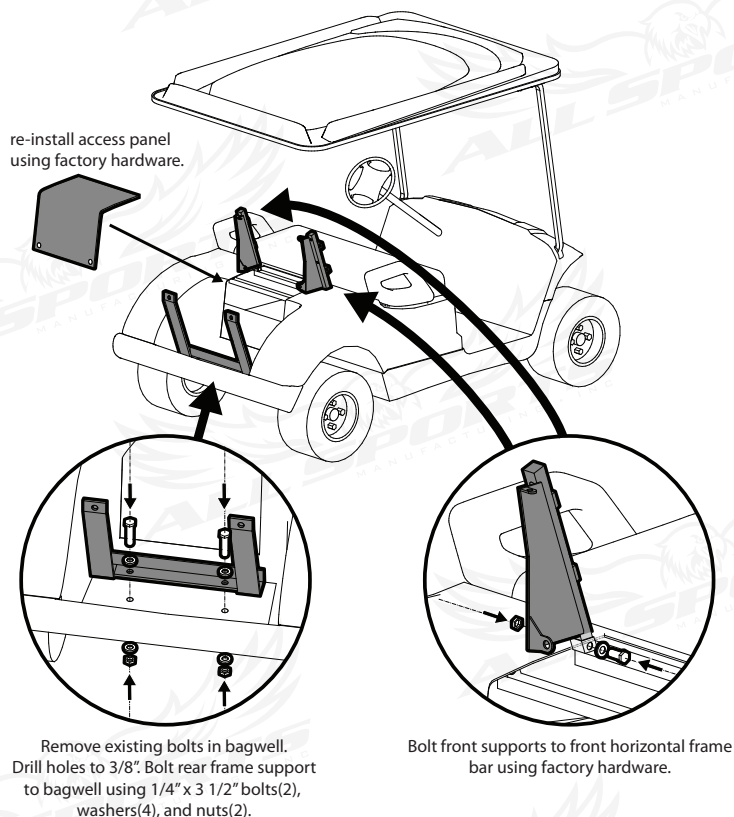

## 6. Install flip seat frame.

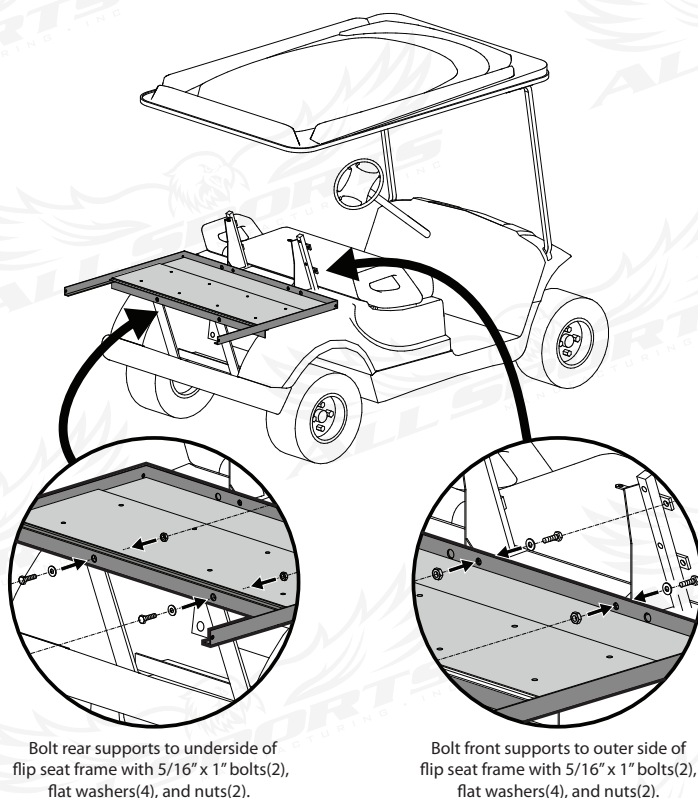

## 7. Install side rails.

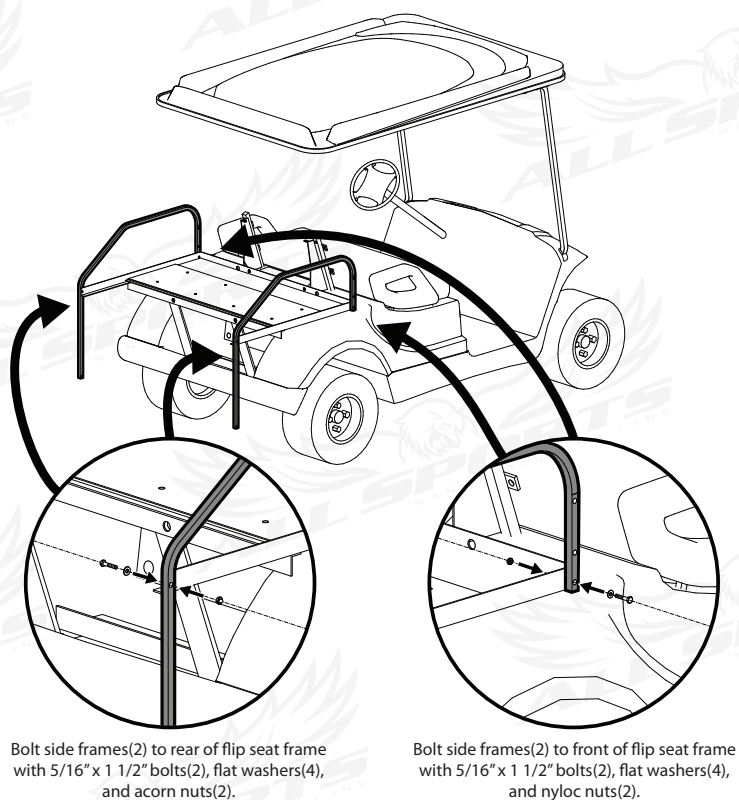

## 8. Install back frame.

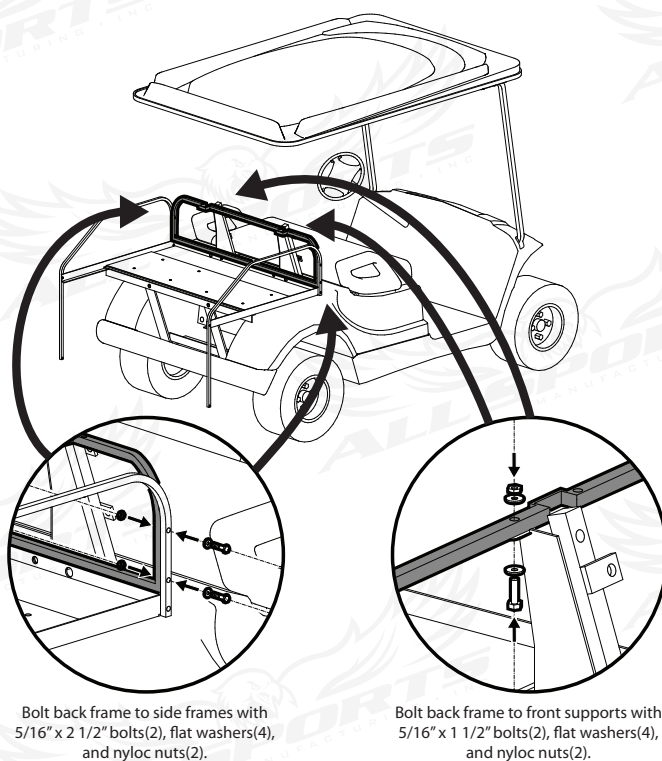

# Installation

## 9. Install step plate.

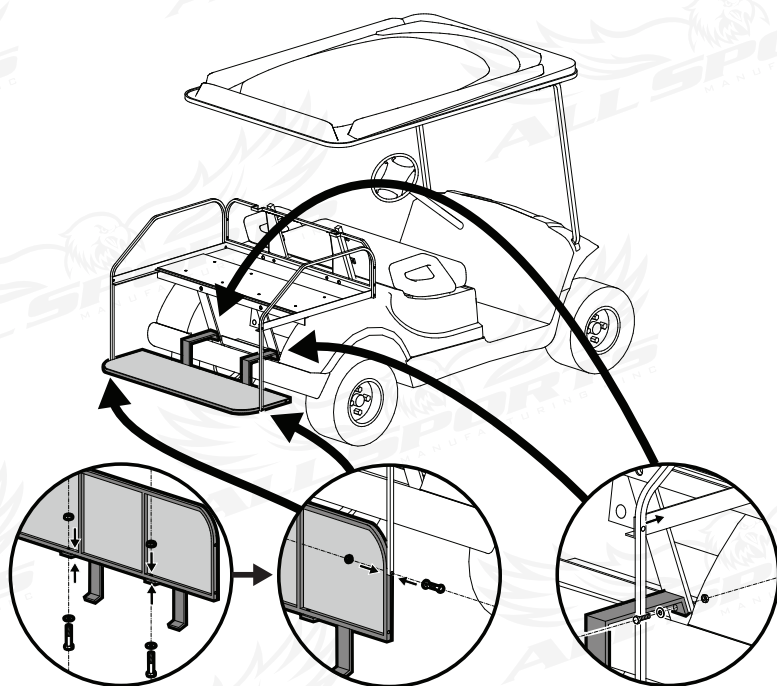

Bolt step plate supports loosely to step plate with 5/16" x 2" bolts(2), flat washers(4), and nuts(2).

Bolt step plate to side frames with 5/16" x 2 1/2" bolts(2), flat washers(4), and nuts(2).

connect step plate supports to rear supports with 5/16" x 1" bolts(2), flat washers(4), and nuts(2).

## 10. Re-install roof supports and seat cushion.

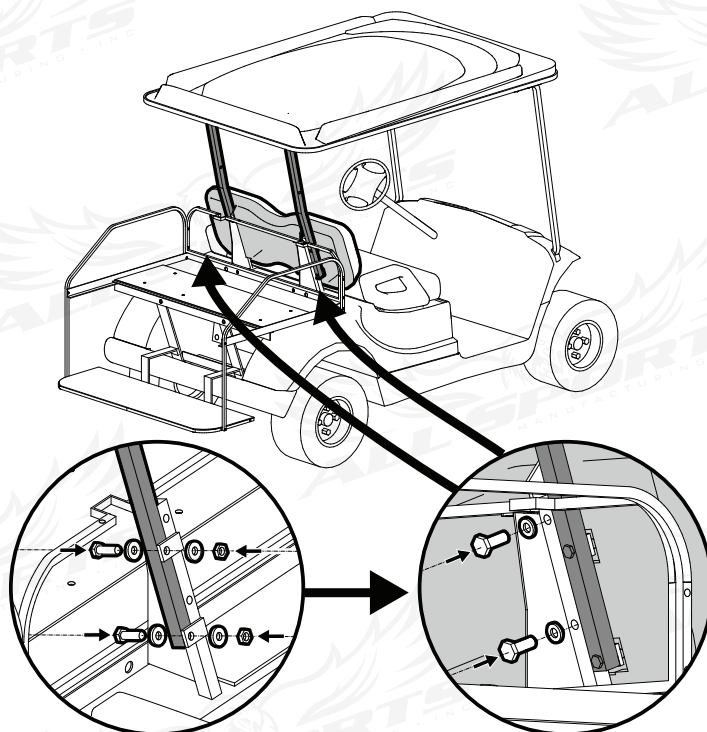

Bolt roof supports to front frame supports using OEM Factory hardware.

Bolt Seat cushion to front frame supports using 1/4" x 1 3/4" bolts(2), and flat washers(2).

## 11. Re-install gutters.

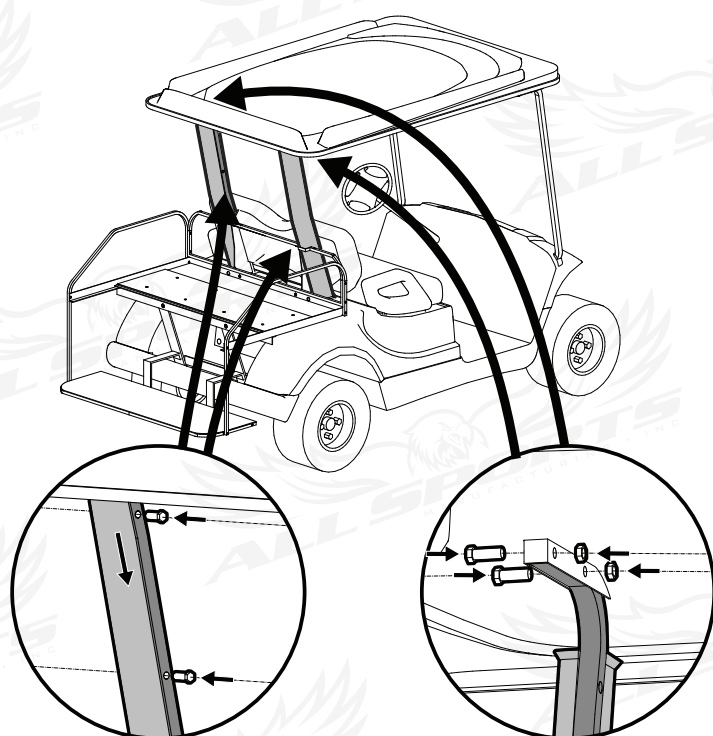

Slide gutter in place and bolt to roof supports using factory hardware.

Bolt roof supports to roof using factory hardware.

## 12. Install rear seat back cushion.

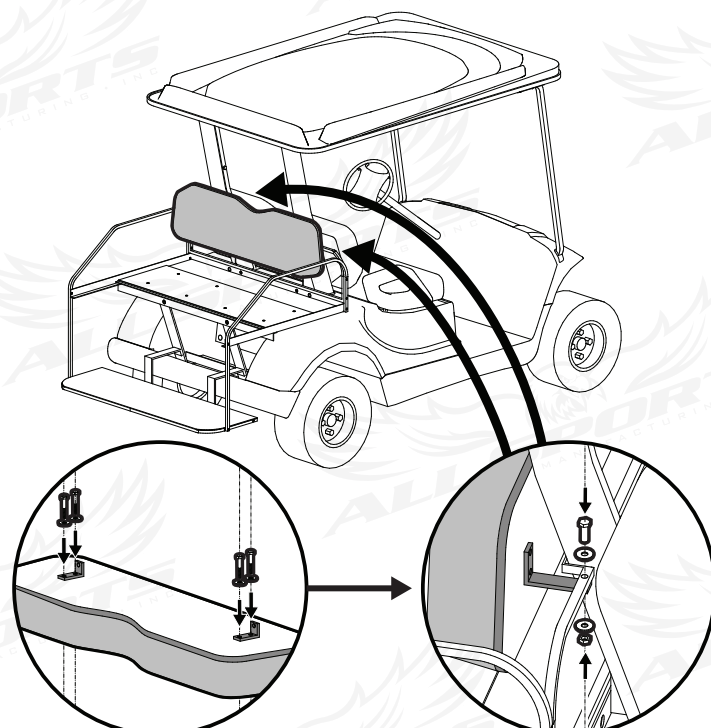

Bolt rear seat supports(2) to back of rear seat back pad with 1/4" x 1" bolts(4) and flat washers(4).

Bolt rear seat back pad to underside of back frame with 1/4" x 1 3/4" bolts(2), flat washers(4), and nuts(2).

# Installation

## 13. Install flip-seat cushion.

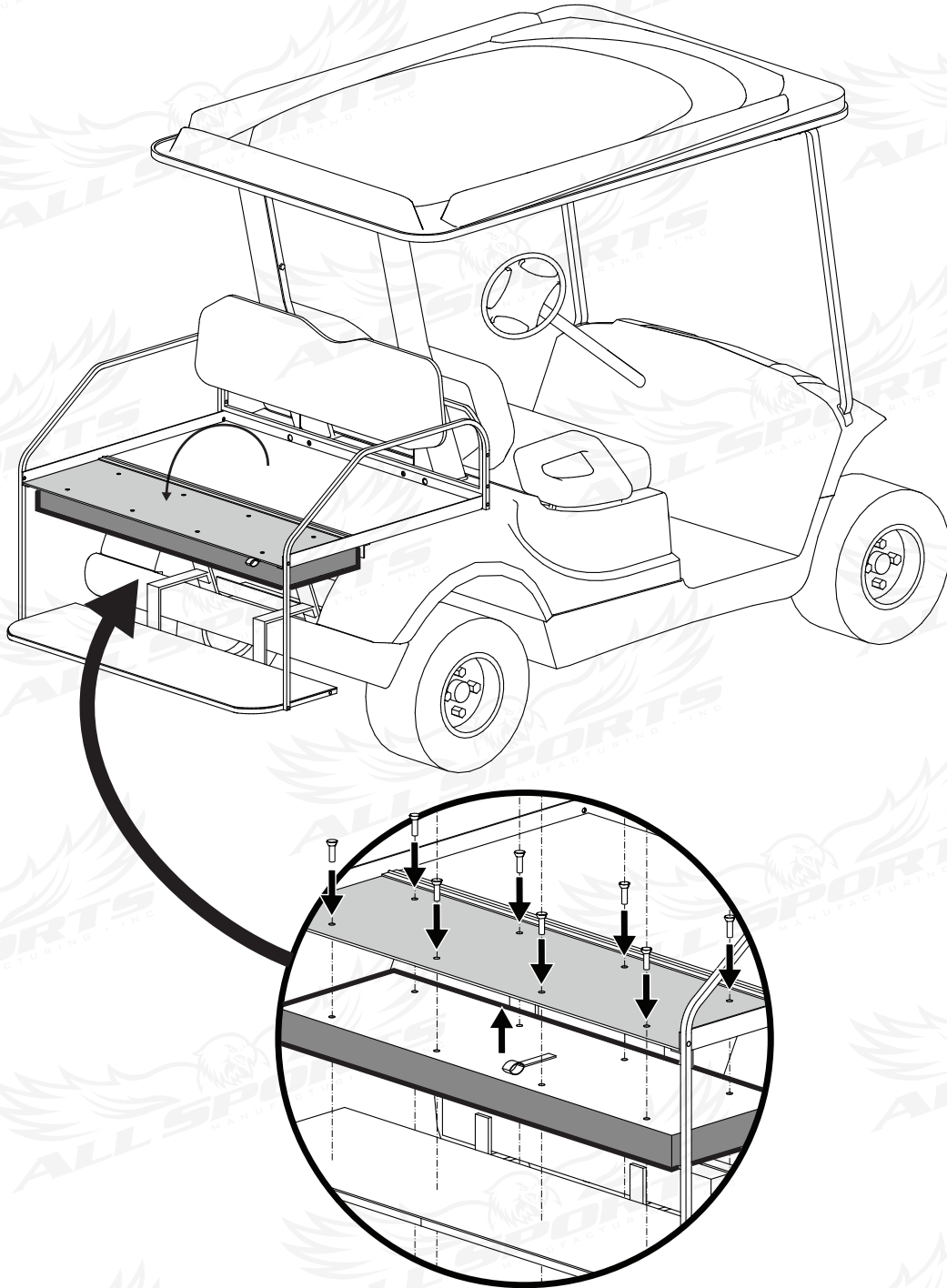

Attach flip-seat cushion to underside of cargo panel with allen bolts(8). Secure seat pull in between pad and panel.